

TEKNA

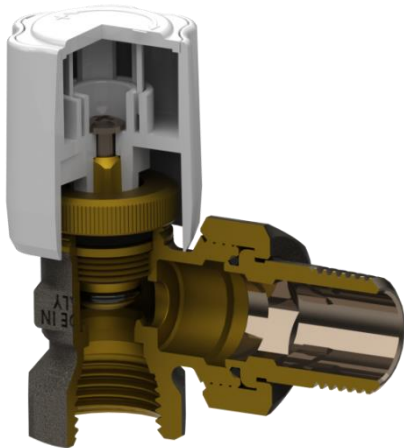

Funzione

The excellent fluid dynamic characteristics and the double tightening system, both towards the outside and the obturator, make TEKNA valves the best choice in terms of quality.

Technical data

Max. working pressure:	10 bar
Max. differential pressure:	1 bar
Max. working temperature:	120 °C
Working fluids:	water in compliance with UNI 8065:2019

Materials

Valve body:	CW 617 N – DW UNI-EN 12165:2016
Obturator:	CW 614 N – DW UNI-EN 12164:2016
Gaskets:	Peroxide cured EPDM
Knob:	RAL9016 white ABS

Surface treatment

Nickel-plating

Dimensional Drawings

RD 01

Single adjustment straight radiator valve.
Connection for iron pipe

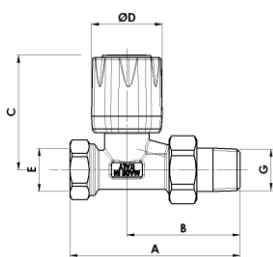

Code	Size	A	B	C	D	E
10221700	DN10 3/8	76	51	55	35	G3/8
10222100	DN15 1/2	82	55	56	35	G1/2
10222700	DN20 3/4	97	65	57	35	G3/4

Code	Size	F	G	H	L	M
10221700	DN10 3/8	-	R3/8	-	-	-
10222100	DN15 1/2	-	R1/2	-	-	-
10222700	DN20 3/4	-	R3/4	-	-	-

RS 02

Single adjustment angle radiator valve.
Connection for iron pipe

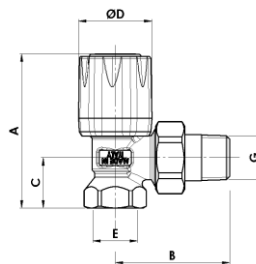

Code	Size	A	B	C	D	E
10021700	DN10 3/8	67	50	20	35	G3/8
10022100	DN15 1/2	71	53	23	35	G1/2
10022700	DN20 3/4	71	62	27	35	G3/4

Code	Size	F	G	H	L	M
10021700	DN10 3/8	-	R3/8	-	-	-
10022100	DN15 1/2	-	R1/2	-	-	-
10022700	DN20 3/4	-	R3/4	-	-	-

RD 05

Single adjustment straight radiator valve with O-ring sealing.
Connection for iron pipe

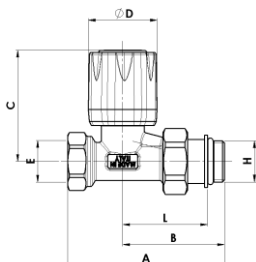

Code	Size	A	B	C	D	E
10222117	DN10 3/8	73	48	55	35	G3/8
10222103	DN15 1/2	78	51	56	35	G1/2
10222703	DN20 3/4	95	63	57	35	G3/4

Code	Size	F	G	H	L	M
10222117	DN10 3/8	-	-	G3/8	38	-
10222103	DN15 1/2	-	-	G1/2	40	-
10222703	DN20 3/4	-	-	G3/4	53	-

RS 06

Single adjustment angle radiator valve with O-ring sealing.
Connection for iron pipe

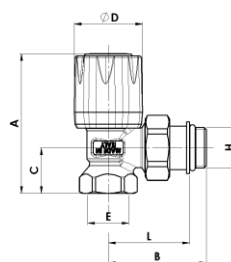

Code	Size	A	B	C	D	E
10022117	DN10 3/8	67	47	20	35	G3/8
10022103	DN15 1/2	71	49	23	35	G1/2
10022703	DN20 3/4	71	60	27	35	G3/4

Code	Size	F	G	H	L	M
10022117	DN10 3/8	-	-	G3/8	37	-
10022103	DN15 1/2	-	-	G1/2	39	-
10022703	DN20 3/4	-	-	G3/4	48	-

RD 11

Single adjustment straight radiator valve.
Connection for copper and plastic pipe W24x19"

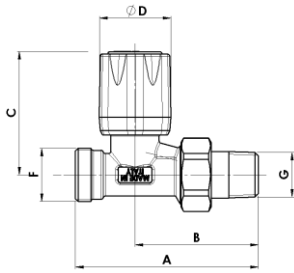

Code	Size	A	B	C	D	E
10321700	DN10 3/8	76	51	55	35	-
10322100	DN15 1/2	81	55	56	35	-
Code	Size	F	G	H	L	M
10321700	DN10 3/8	W24x19	R3/8	-	-	-
10322100	DN15 1/2	W24x19	R1/2	-	-	-

RS 12

Single adjustment angle radiator valve.
Connection for copper and plastic pipe W24x19"

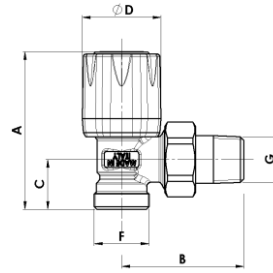

Code	Size	A	B	C	D	E
10121700	DN10 3/8	66	50	19	35	-
10122100	DN15 1/2	70	54	22	35	-
Code	Size	F	G	H	L	M
10121700	DN10 3/8	W24x19	R3/8	-	-	-
10122100	DN15 1/2	W24x19	R1/2	-	-	-

RD 18

Single adjustment straight radiator valve with O-ring sealing.
Connection for copper and plastic pipe W24x19"

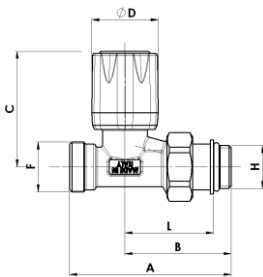

Code	Size	A	B	C	D	E
10322117	DN10 3/8	73	48	55	35	-
10322103	DN15 1/2	77	51	56	35	-
Code	Size	F	G	H	L	M
10322117	DN10 3/8	W24x19	-	G3/8	38	-
10322103	DN15 1/2	W24x19	-	G1/2	40	-

RS 19

Single adjustment angle radiator valve with O-ring sealing.
Connection for copper and plastic pipe W24x19"

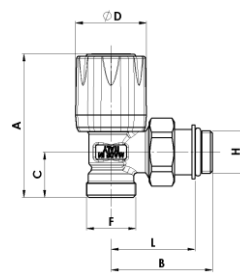

Code	Size	A	B	C	D	E
10122117	DN10 3/8	66	47	19	35	-
10122103	DN15 1/2	70	49	22	35	-
Code	Size	F	G	H	L	M
10122117	DN10 3/8	W24x19	-	G3/8	37	-
10122103	DN15 1/2	W24x19	-	G1/2	39	-

RD 11/A

Single adjustment straight radiator valve.
Connection for copper and plastic pipe G3/4 Eurokonus

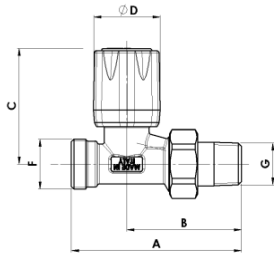

Code	Size	A	B	C	D	E
------	------	---	---	---	---	---

10322719	DN10 3/8	76	51	55	35	-
----------	----------	----	----	----	----	---

10322722	DN15 1/2	82	55	56	35	-
----------	----------	----	----	----	----	---

Code	Size	F	G	H	L	M
------	------	---	---	---	---	---

10322719	DN10 3/8	G3/4EK	R3/8	-	-	-
----------	----------	--------	------	---	---	---

10322722	DN15 1/2	G3/4EK	R1/2	-	-	-
----------	----------	--------	------	---	---	---

RS 12/A

Single adjustment angle radiator valve.
Connection for copper and plastic pipe G3/4 Eurokonus

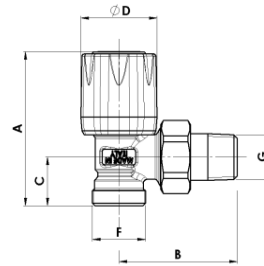

Code	Size	A	B	C	D	E
------	------	---	---	---	---	---

10122718	DN10 3/8	66	50	19	35	-
----------	----------	----	----	----	----	---

10122721	DN15 1/2	70	54	22	35	-
----------	----------	----	----	----	----	---

Code	Size	F	G	H	L	M
------	------	---	---	---	---	---

10122718	DN10 3/8	G3/4EK	R3/8	-	-	-
----------	----------	--------	------	---	---	---

10122721	DN15 1/2	G3/4EK	R1/2	-	-	-
----------	----------	--------	------	---	---	---

RD 18/A

Single adjustment straight radiator valve with O-ring sealing.
Connection for copper and plastic pipe G3/4 Eurokonus

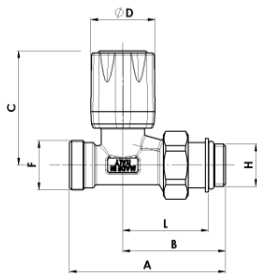

Code	Size	A	B	C	D	E
------	------	---	---	---	---	---

10322717	DN10 3/8	73	48	55	35	-
----------	----------	----	----	----	----	---

10322703	DN15 1/2	77	51	56	35	-
----------	----------	----	----	----	----	---

Code	Size	F	G	H	L	M
------	------	---	---	---	---	---

10322717	DN10 3/8	G3/4EK	-	G3/8	38	-
----------	----------	--------	---	------	----	---

10322703	DN15 1/2	G3/4EK	-	G1/2	40	-
----------	----------	--------	---	------	----	---

RS 19/A

Single adjustment angle radiator valve with O-ring sealing.
Connection for copper and plastic pipe G3/4 Eurokonus

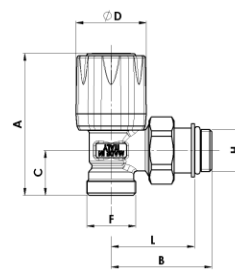

Code	Size	A	B	C	D	E
------	------	---	---	---	---	---

10122717	DN10 3/8	66	47	19	35	-
----------	----------	----	----	----	----	---

10122703	DN15 1/2	70	49	22	35	-
----------	----------	----	----	----	----	---

Code	Size	F	G	H	L	M
------	------	---	---	---	---	---

10122717	DN10 3/8	G3/4EK	-	G3/8	37	-
----------	----------	--------	---	------	----	---

10122703	DN15 1/2	G3/4EK	-	G1/2	39	-
----------	----------	--------	---	------	----	---

M 300

Single adjustment reverse angle radiator valve.
Connection for copper and plastic pipe G3/4 Eurokonus

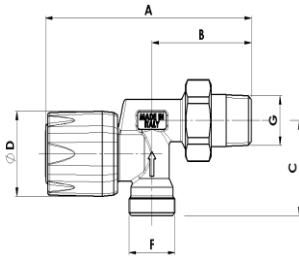

Code	Size	A	B	C	D	E
13062100	DN15 1/2	108	52	39	35	-
-	-	-	-	-	-	-
Code	Size	F	G	H	L	M
13062100	DN15 1/2	W24x19	-	R1/2	-	-
-	-	-	-	-	-	-

M 302

Single adjustment reverse angle radiator valve.
Connection for iron pipe

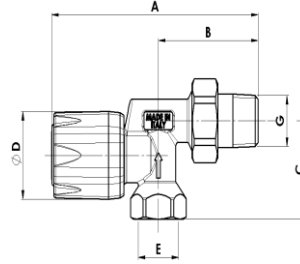

Code	Size	A	B	C	D	E
13162100	DN15 1/2	108	52	39	35	-
-	-	-	-	-	-	-
Code	Size	F	G	H	L	M
13162100	DN15 1/2	W24x19	-	R1/2	-	-
-	-	-	-	-	-	-

Hydraulic Characteristics

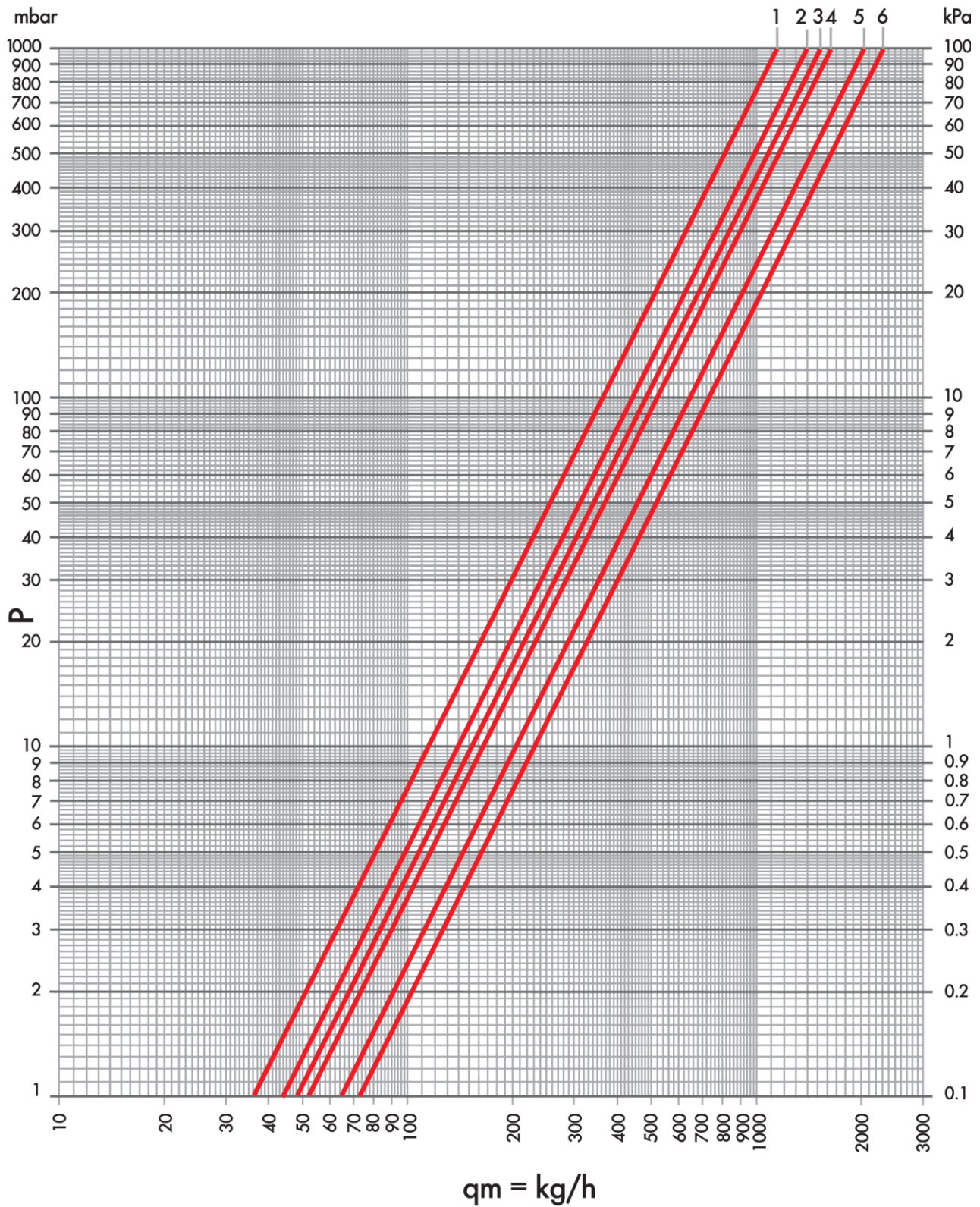

Curve	Kv	Items
1	1.15	RD 01 3/8; RD 05 3/8; RD 11 3/8; RD 18 3/8; RD 18/A 3/8
2	1.40	RD 01 1/2; RD 05 1/2; RD 11 1/2; RD 11/A 1/2; RD 18 1/2; RD 18/A 1/2
3	1.53	RD 01 3/4; RD 05 3/4
4	1.65	RS 02 3/8; RS 06 3/8; RS 12 3/8; RS 19 3/8; RS 19/A 3/8
5	2.06	RS 02 1/2; RS 06 1/2; RS 12 1/2; RS 12/A 1/2; RS 19 1/2; RS 19/A 1/2
6	2.31	RS 02 3/4; RS 06 3/4

Hydraulic Characteristics

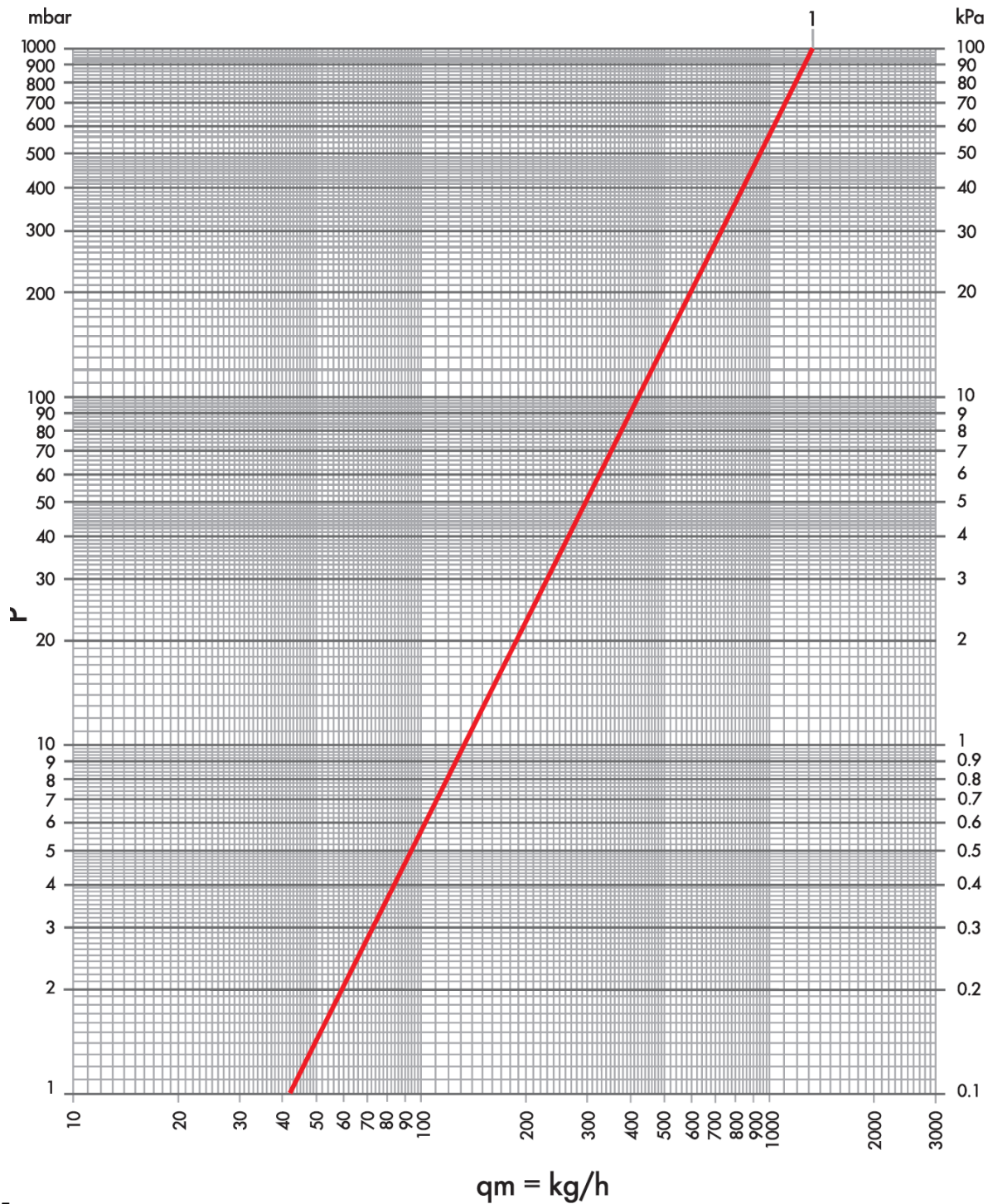

15

Curve	Kv	Items
1	1.31	M 300 1/2; M 302 1/2.

Working Instructions

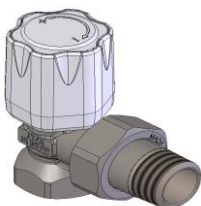

The valve may be adjusted by using the ABS knob. Turn clockwise to reduce the flow rate or close the valve. Turn anti-clockwise to increase the flow rate.

WARNING: Once the system has been leak tested, please relieve the pressure. A differential pressure over 1 bar between the inlet and the outlet of the valve may cause the sealing O-ring to be expelled.

Item Specifications

RD 01

Straight manual radiator valve with white ABS knob. ISO 228/1 connection for iron pipe 3/8"F, 1/2"F and 3/4"F. Radiator connection with prefitted peroxide cured EPDM O-ring and DIN 2999 conical thread 3/8"M, 1/2"M and 3/4"M. Valve body in nickel-plated CW617N brass. Peroxide cured EPDM O-ring and PTFE flat gasket. Max. working temp. 120 °C, max. working pressure 10 bar, differential pressure 1 bar.

RS 02

Angle manual radiator valve with white ABS knob. ISO 228/1 connection for iron pipe 3/8"F, 1/2"F and 3/4"F. Radiator connection with prefitted peroxide cured EPDM O-ring and DIN 2999 conical thread 3/8"M, 1/2"M and 3/4"M. Valve body in nickel-plated CW617N brass. Peroxide cured EPDM O-ring and PTFE flat gasket. Max. working temp. 120 °C, max. working pressure 10 bar, differential pressure 1 bar.

RD 05

Straight manual radiator valve with white ABS knob. ISO 228/1 connection for iron pipe 3/8"F, 1/2"F and 3/4"F. Radiator connection with prefitted peroxide cured EPDM O-ring, cylindrical thread 3/8"M, 1/2"M and 3/4"M and O-ring. Valve body in nickel-plated CW617N brass. Peroxide cured EPDM O-ring and PTFE flat gasket. Max. working temp. 120 °C, max. working pressure 10 bar, differential pressure 1 bar.

RS 06

Angle manual radiator valve with white ABS knob. ISO 228/1 connection for iron pipe 3/8"F, 1/2"F and 3/4"F. Radiator connection with prefitted peroxide cured EPDM O-ring, cylindrical thread 3/8"M, 1/2"M and 3/4"M and O-ring. Valve body in nickel-plated CW617N brass. Peroxide cured EPDM O-ring and PTFE flat gasket. Max. working temp. 120 °C, max. working pressure 10 bar, differential pressure 1 bar.

RD 11

Straight manual radiator valve with white ABS knob. W24x19 connection for copper, plastic and multilayer pipe. Radiator connection with prefitted peroxide cured EPDM O-ring and DIN 2999 conical thread 3/8"M and 1/2"M. Valve body in nickel-plated CW617N brass. Peroxide cured EPDM O-ring and PTFE flat gasket. Max. working temp. 120 °C, max. working pressure 10 bar, differential pressure 1 bar.

RS 12

Angle manual radiator valve with white ABS knob. W24x19 connection for copper, plastic and multilayer pipe. Radiator connection with prefitted peroxide cured EPDM O-ring and DIN 2999 conical thread 3/8"M and 1/2"M. Valve body in nickel-plated CW617N brass. Peroxide cured EPDM O-ring and PTFE flat gasket. Max. working temp. 120 °C, max. working pressure 10 bar, differential pressure 1 bar.

RD 18

Straight manual radiator valve with white ABS knob. W24x19 connection for copper, plastic and multilayer pipe. Radiator connection with prefitted peroxide cured EPDM O-ring, cylindrical thread 3/8"M and 1/2"M and O-ring. Valve body in nickel-plated CW617N brass. Peroxide cured EPDM O-ring and PTFE flat gasket. Max. working temp. 120 °C, max. working pressure 10 bar, differential pressure 1 bar.

RS 19

Angle manual radiator valve with white ABS knob. W24x19 connection for copper, plastic and multilayer pipe. Radiator connection with prefitted peroxide cured EPDM O-ring, cylindrical thread 3/8"M and 1/2"M and O-ring. Valve body in nickel-plated CW617N brass. Peroxide cured EPDM O-ring and PTFE flat gasket. Max. working temp. 120 °C, max. working pressure 10 bar, differential pressure 1 bar.

RD 11/A

Straight manual radiator valve with white ABS knob. Connection for copper, plastic and multilayer pipe 3/4"M EK. Radiator connection with prefitted peroxide cured EPDM O-ring and DIN 2999 conical thread 1/2"M. Valve body in nickel-plated CW617N brass. Peroxide cured EPDM O-ring and PTFE flat gasket. Max. working temp. 120 °C, max. working pressure 10 bar, differential pressure 1 bar.

RS 12/A

Angle manual radiator valve with white ABS knob. Connection for copper, plastic and multilayer pipe 3/4"M EK. Radiator connection with prefitted peroxide cured EPDM O-ring and DIN 2999 conical thread 1/2"M. Valve body in nickel-plated CW617N brass. Peroxide cured EPDM O-ring and PTFE flat gasket. Max. working temp. 120 °C, max. working pressure 10 bar, differential pressure 1 bar.

RD 18/A

Straight manual radiator valve with white ABS knob. Connection for copper, plastic and multilayer pipe 3/4"M EK. Radiator connection with prefitted peroxide cured EPDM O-ring, cylindrical thread 3/8"M and 1/2"M and O-ring. Valve body in nickel-plated CW617N brass. Peroxide cured EPDM O-ring and PTFE flat gasket. Max. working temp. 120 °C, max. working pressure 10 bar, differential pressure 1 bar.

10 bar, differential pressure 1 bar.

RS 19/A

Angle manual radiator valve with white ABS knob. Connection for copper, plastic and multilayer pipe 3/4" M EK. Radiator connection with prefitted peroxide cured EPDM O-ring, cylindrical thread 3/8" M and 1/2" M and O-ring. Valve body in nickel-plated CW617N brass. Peroxide cured EPDM O-ring and PTFE flat gasket. Max. working temp. 120 °C, max. working pressure 10 bar, differential pressure 1 bar.

M 300

Reverse angle manual radiator valve with white ABS knob. W24x19 connection for copper, plastic and multilayer pipe. Radiator connection with prefitted peroxide cured EPDM O-ring, cylindrical thread 1/2" M. Valve body in nickel-plated CW617N brass. Peroxide cured EPDM O-ring and PTFE flat gasket. Max. working temp. 120 °C, max. working pressure 10 bar, differential pressure 1 bar.

M 302

Reverse angle manual radiator valve with white ABS knob. ISO 228/1 connection for copper, plastic and multilayer pipe 1/2" F. Radiator connection with prefitted peroxide cured EPDM O-ring and DIN 2999 conical thread 1/2" M. Valve body in nickel-plated CW617N brass. Peroxide cured EPDM O-ring and PTFE flat gasket. Max. working temp. 120 °C, max. working pressure 10 bar, differential pressure 1 bar.



Luxor S.p.A.

Sede amministrativa, stabilimento e uffici commerciali:

Administrative office, factory and commercial office:

Tel.: 030-9961161 – Fax: 030-9961165

info@luxor.it – www.luxor.it

via Madonnina, 94 – 25018 Montichiari - (BS) Italy

*Luxor si riserva il diritto di apportare miglioramenti e modifiche ai prodotti descritti ed ai relativi dati tecnici in qualsiasi momento e senza preavviso -
Luxor reserves the right to ameliorate and modify the above products and their technical data at any time and without notice*