



Function

Luxor manufactures a wide range of fittings and union fittings to fit a number of different types of installation.

Technical data

Max. working pressure:	10 bar
Max. differential pressure:	1 bar
Max. working temperature:	120 °C
Working fluids:	water in compliance with UNI 8065:2019

Materials

Body

Valve body:	CW 617 N – DW UNI-EN 12165:2016
Components:	CW 614 N – DW UNI-EN 12164:2016
Gaskets:	Peroxide cured EPDM

Thermometer

Case and stem:	Galvanised steel
Cover:	Transparent plastic material
Thermometric element:	Bimetallic spiral spring

Manual air vent valves

Valve body:	CW 614 N – DW UNI-EN 12164:2016
Valve body:	Thermoresistant plastic material
Gaskets:	Peroxide cured EPDM

Fill/Drain taps

Terminal body:	CW 617 N – DW UNI-EN 12165:2016
Valve body:	CW 617 N – DW UNI-EN 12165:2016
Gaskets:	Peroxide cured EPDM

Automatic air vent valves

Valve body:	CW 617 N – DW UNI-EN 12165:2016
Float:	PP
Gaskets:	NBR
Spring:	Stainless steel

Surface treatment

Nickel-plating

Dimensional Drawings

CR 489

Union fitting with O-ring and counter ring nut for ball valve with 3 connections.

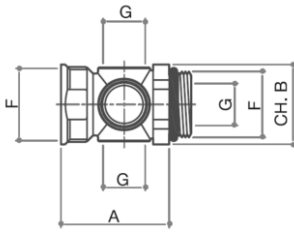

Code	Size	A	B	C	F	G
68503425	G1" x G1/2	54	37	-	G1"	G1/2

CR 491

Union fitting with O-ring and revolving nut for ball valve with 3 connections.

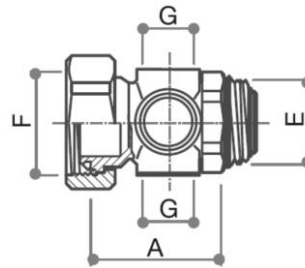

Code	Size	A	B	E	F	G
68559781	G1" x G1/2	53	-	G1"	G1"1/4	G1/2
68559785	G1"1/4 x G1/2	66	-	G1"1/4	G1"1/4	G1/2

CR 490

Union fitting with gasket and counter ring nut for ball valve with adjustable thermometer, automatic air vent valve and adjustable drain tap.

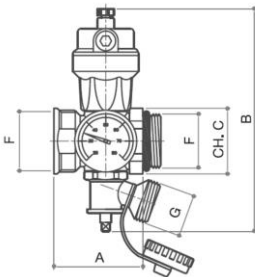

Code	Size	A	B	C	F	G
68503430	G 1"	54	136	37	G1"	G3/4

CR 492

Union fitting with gasket and counter ring nut for ball valve with adjustable thermometer, manual air vent valve and adjustable drain tap.

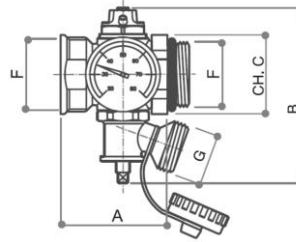

Code	Size	A	B	C	F	G
68503434	G 1"	54	90	37	G1"	G3/4

CR 498

Nickel-plated nut and fitting with O-ring to connect valves to distribution manifolds.

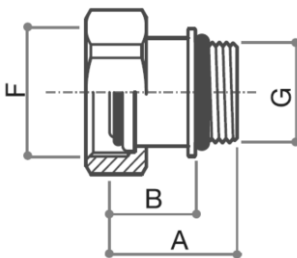

Code	Size	A	B	C	F	G
67901700	DN10 3/8	26	18	-	G5/8	G3/8
67902100	DN15 1/2	26	18	-	G3/4	G1/2
67902700	DN20 3/4	33	23	-	G1"	G3/4
67903400	DN25 1"	36	25	-	G1"1/4	G1"
67904200	DN32 1"1/4	41	35	-	G1"1/2	G1"1/4

CR 498/A

Nickel-plated nut and fitting with flat gasket to connect valves to distribution manifolds.

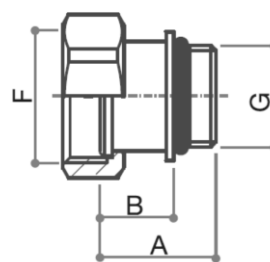

Code	Size	A	B	C	F	G
67922100	DN15 1/2	23	15	-	G3/4	G1/2
67922700	DN20 3/4	29.5	19.5	-	G1"	G3/4
67924200	DN32 1"1/4	36	22.5	-	G1"1/2	G1"1/4

CR 498/B

CR 498 fitting increased by 50mm.

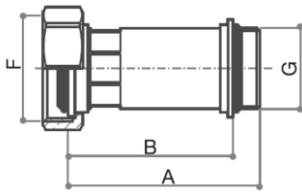

Code	Size	A	B	C	F	G
67913400	DN25 1"	77	66	-	G1"1/4	G1"

CR 499

Nickel-plated fitting with revolving nut, counter ring nut and O-ring, complete with thermometer, for the connection of ball valves to distribution manifolds CD.

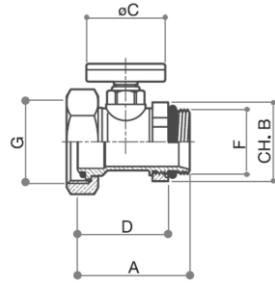

Code	Size	A	B	C	D	E
68503428	G 1"	57	37	40	46	-
68504228	G 1"1/4	66	47	20	32	-

Code	Size	F	G	H	L	M
68503428	G 1"	G1"	G1"1/4	-	-	-
68504228	G 1"1/4	G1"1/4	G1"1/2	-	-	-

Item Specifications

CR 489

Brass body. Gaskets and O-rings in peroxide cured EPDM. Fixed threaded female connection. Fixed male connection with locking nut. Three threaded female connections for accessories. Max. working pressure 10 bar. Max. fluid temperature 120°C.

CR 491

Brass body. Gaskets and O-rings in peroxide cured EPDM. Connection with threaded female nut. Fixed male connection with locking nut. Three threaded female connections for accessories. Max. working pressure 10 bar. Max. fluid temperature 120°C.

CR 490

Brass body. Gaskets and O-rings in peroxide cured EPDM. Connection with threaded female nut. Fixed male connection with locking nut. Thermometer precision $\pm 2^{\circ}\text{C}$ with 1/2" housing, reading field 0-80°C. Fill/Drain tap and automatic air vent valve. Max. working pressure 10 bar. Max. fluid temperature 120°C.

CR 492

Brass body. Gaskets and O-rings in peroxide cured EPDM. Connection with threaded female nut. Fixed male connection with locking nut. Thermometer precision $\pm 2^{\circ}\text{C}$ with 1/2" housing, reading field 0-80°C. Fill/Drain tap and manual air vent valve. Max. working pressure 10 bar. Max. fluid temperature 120°C.

CR 498

Brass fitting. Gaskets and O-rings in peroxide cured EPDM. Connection with threaded female nut. Fixed male connection. Max. working pressure 10 bar. Max. fluid temperature 120°C.

CR 498/A

Brass fitting. Gaskets and O-rings in peroxide cured EPDM. Connection with threaded female nut. Fixed male connection. Max. working pressure 10 bar. Max. fluid temperature 120°C.

CR 498/B

Brass fitting. Gaskets and O-rings in peroxide cured EPDM. Connection with threaded female nut. Fixed male connection. Max. working pressure 10 bar. Max. fluid temperature 120°C.

CR 499

Brass body. Thermometer precision $\pm 2^{\circ}\text{C}$ with 3/8" housing, reading field 0-80°C. Gaskets and O-rings in peroxide cured EPDM. Connection with threaded female nut. Fixed male connection with locking nut. Max. working pressure 10 bar. Max. fluid temperature 120°C.



Luxor S.p.A.

Sede amministrativa, stabilimento e uffici commerciali:

Administrative office, factory and commercial office:

Tel.: 030-9961161 – Fax: 030-9961165

info@luxor.it – www.luxor.it

via Madonnina, 94 – 25018 Montichiari - (BS) Italy

*Luxor si riserva il diritto di apportare miglioramenti e modifiche ai prodotti descritti ed ai relativi dati tecnici in qualsiasi momento e senza preavviso -
Luxor reserves the right to ameliorate and modify the above products and their technical data at any time and without notice*