



RADIATOR VALVES

**1.4 / SERIES 50<sup>th</sup>**

# SERIE 50<sup>th</sup> RADIATOR VALVES



The screw of Serie 50th valves allows to preset the flow thanks to a shaped acetal ring. The thermostatic screw enables to replace one of the o-rings on the control stem without draining the system.



The tightness of Serie 50th lockshields is ensured by an o-ring on the obturator and, if necessary, by a further o-ring between the body and the plug. When in closed position, the tightness is granted by an o-ring and a conical metal collar. The lockshields are available in chrome plated or white/chrome plated version. All lockshields allow for flow adjustment by limiting the lift of the obturator.



The Serie 50th manual valve features a fixed stem, whose tightness is ensured by two o-rings. When in closed position, the tightness is granted by a flat gasket. The valves are available in chrome plated and white/chrome plated version. Valves and lockshields must be opened with a differential pressure lower than 1 bar.

### TECHNICAL DATA



DN  
15



Max temperature  
120 °C



Max pressure  
10 bar



Max differential pressure (thermostatic valves)  
0,6 bar



Max differential pressure  
1 bar



Materials  
CW617N  
UNI EN  
12165:2016



Knob  
Plated ABS  
white ABS  
RAL 9016



Stem  
AISI 316

### SYSTEM CONNECTIONS

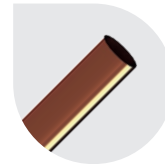

**Copper pipe**  
G 3/4 EK - TR 91/AC

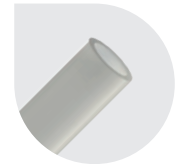

**Plastic pipe**  
G 3/4 EK - TP 98/C



**Multilayer pipe**  
G 3/4 EK - TP 99/C

### RADIATOR CONNECTION



**Cylindrical thread with soft sealing**  
G 1/2

### FINISH



chrome



white-chrome



white

### HOW TO SELECT THE CORRECT COAXIAL VALVES

#### COAXIAL RIGHT THERMOSTATIC KIT

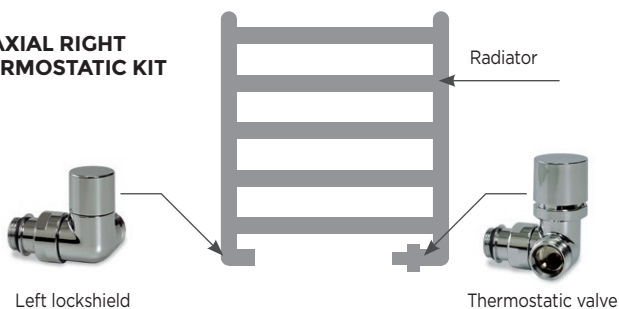

#### COAXIAL LEFT THERMOSTATIC KIT

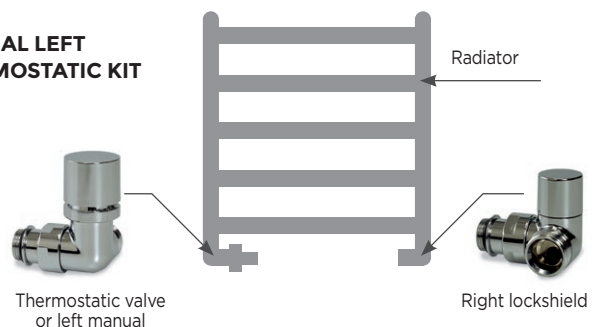

The characteristics of the fluid in the system must be compliant with the UNI 8065: 2019 directive.

## FLOW ADJUSTMENT

To adjust the maximum flow rate, proceed as follows:

- align the reference mark on the stainless steel stem with one of the positions marked on the valve.

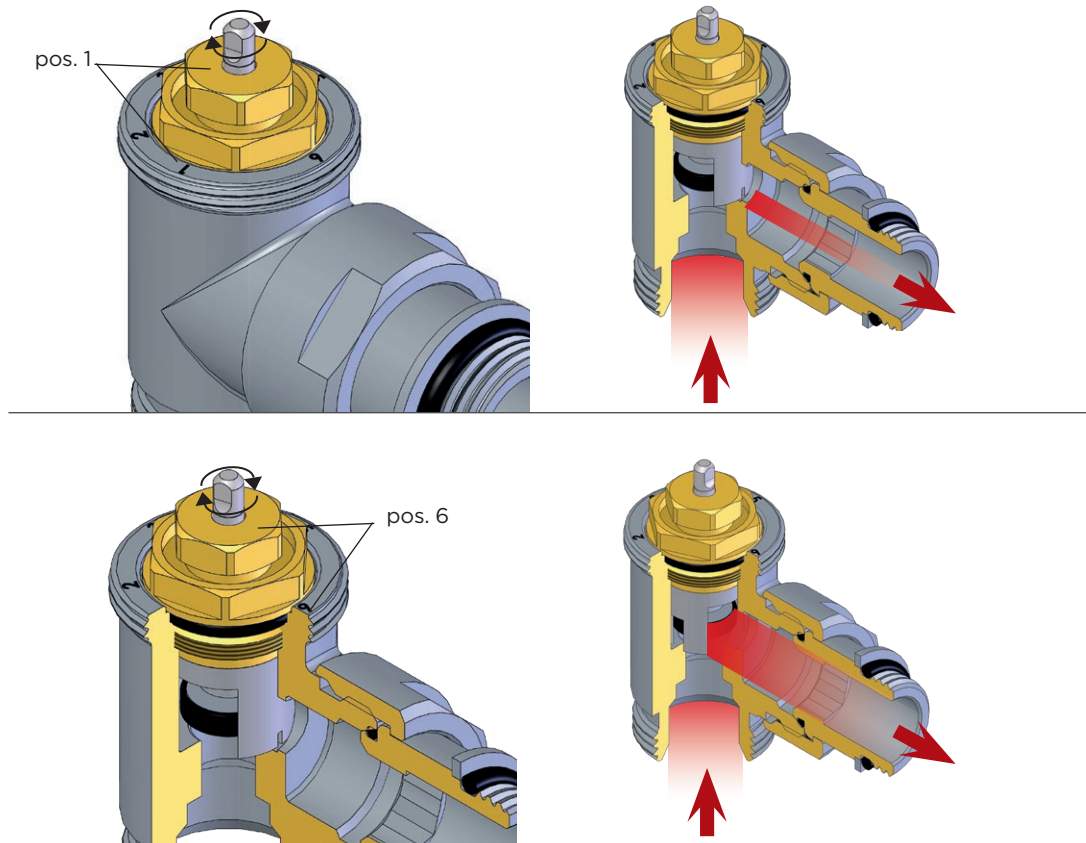

## TIGHTNESS ON THE STEM

The tightening system can be easily replaced without draining the system:

- unscrew the hexagonal collar with a 13 mm wrench key;
- remove the o-ring "art. 582 - code 3424602", clean the stainless steel stem, insert a new o-ring "art. 582";
- assemble the collar screwing tight.



### REPLACEMENT OF THE SCREW

Thanks to article CH 111- code 67822719 the screw can be replaced while the system is operating and without draining it.

## THERMOSTATIC KIT: CONNECTION FOR COPPER AND PLASTIC PIPE G3/4 EUROKONUS



CHROME







WHITE-CHROME

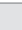

WHITE

### KT 259/A

Complete angle thermostatic kit for radiator connection. Consisting of RS 259/A + DS 79/A + TT 3000C. Eurokonus connection.

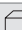
CODE	SIZE	FINISH						
14702703	DN 15 1/2	CHROME	TR 91/AC	TP 98/C	TP 99/C	603	1	12
14702703CB	DN 15 1/2	WHITE-CHROME	TR 91/AC	TP 98/C	TP 99/C	604	1	12
14702703B	DN 15 1/2	WHITE	TR 91/AC	TP 98/C	TP 99/C	604	1	12



CHROME







WHITE-CHROME

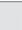

WHITE

### KT 258/A

Complete straight thermostatic kit for radiator connection. Consisting of RD 258/A + DD 78/A + TT 3000C. Eurokonus connection.

CODE	SIZE	FINISH						
14902703	DN 15 1/2	CHROME	TR 91/AC	TP 98/C	TP 99/C	663	1	12
14902703CB	DN 15 1/2	WHITE-CHROME	TR 91/AC	TP 98/C	TP 99/C	664	1	12
14902703B	DN 15 1/2	WHITE	TR 91/AC	TP 98/C	TP 99/C	664	1	12



CHROME







WHITE-CHROME

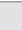

WHITE

### KT 269/A

Complete coaxial right thermostatic kit for radiator connection. Consisting of RCD 269/A + DCS 33/A + TT 3000C. Eurokonus connection.

CODE	SIZE	FINISH						
14772703	DN 15 1/2	CHROME	TR 91/AC	TP 98/C	TP 99/C	655	1	12
14772703CB	DN 15 1/2	WHITE-CHROME	TR 91/AC	TP 98/C	TP 99/C	658	1	12
14772703B	DN 15 1/2	WHITE	TR 91/AC	TP 98/C	TP 99/C	658	1	12





CHROME



WHITE-CHROME



WHITE

**KT 273/A**

Complete coaxial left thermostatic kit for radiator connection. Consisting of RCS 273/A + DCD 29/A + TT 3000C. Eurokonus connection.

CODE	SIZE	FINISH						
14792703	DN 15 1/2	CHROME	TR 91/AC	TP 98/C	TP 99/C	655	1	12
14792703CB	DN 15 1/2	WHITE-CHROME	TR 91/AC	TP 98/C	TP 99/C	658	1	12
14792703B	DN 15 1/2	WHITE	TR 91/AC	TP 98/C	TP 99/C	658	1	12



CHROME



WHITE-CHROME



WHITE

**KT 2059/A**

Complete angle thermostatic kit for radiator connection. Consisting of RS 2059/A + DS 79/A. Eurokonus connection.

CODE	SIZE	FINISH						
14742703	DN 15 1/2	CHROME	TR 91/AC	TP 98/C	TP 99/C	503	1	12
14742703CB	DN 15 1/2	WHITE-CHROME	TR 91/AC	TP 98/C	TP 99/C	507	1	12
14742703B	DN 15 1/2	WHITE	TR 91/AC	TP 98/C	TP 99/C	507	1	12

Kit with fittings included.

CODE	SIZE	FINISH			
14010001	DN 15 1/2	CHROME	503	1	12
14010001CB	DN 15 1/2	WHITE-CHROME	507	1	12
14010001B	DN 15 1/2	WHITE	507	1	12

	Fitting	Code	Size
2x	TR 91/AC	67761200C	12 mm
2x	TR 91/AC	67761400C	14 mm
2x	TP 99/C	67861612C	16x2



Fittings for copper pipe



Fittings for plastic pipe



Fittings for multilayer pipe



Fittings: chapter 7



Accessories: chapter 1.A



CHROME



WHITE-CHROME



WHITE

**KT 2058/A**

Complete straight thermostatic kit for radiator connection. Consisting of RD 2058/A + DD 78/A. Eurokonus connection.

CODE	SIZE	FINISH						
14942703	DN 15 1/2	CHROME	TR 91/AC	TP 98/C	TP 99/C	565	1	12
14942703CB	DN 15 1/2	WHITE-CHROME	TR 91/AC	TP 98/C	TP 99/C	567	1	12
14942703B	DN 15 1/2	WHITE	TR 91/AC	TP 98/C	TP 99/C	567	1	12



CHROME



WHITE-CHROME



WHITE

**KT 2069/A**

Complete coaxial right thermostatic kit for radiator connection. Consisting of RCD 2069/A + DCS 33/A. Eurokonus connection.

CODE	SIZE	FINISH						
14812703	DN 15 1/2	CHROME	TR 91/AC	TP 98/C	TP 99/C	557	1	12
14812703CB	DN 15 1/2	WHITE-CHROME	TR 91/AC	TP 98/C	TP 99/C	561	1	12
14812703B	DN 15 1/2	WHITE	TR 91/AC	TP 98/C	TP 99/C	561	1	12

Kit with fittings included.

CODE	SIZE	FINISH			
14010002	DN 15 1/2	CHROME	503	1	12
14010002CB	DN 15 1/2	WHITE-CHROME	507	1	12
14010002B	DN 15 1/2	WHITE	507	1	12

	Fitting	Code	Size
2x	TR 91/AC	67761200C	12 mm
2x	TR 91/AC	67761400C	14 mm
2x	TP 99/C	67861612C	16x2





CHROME



WHITE-CHROME



WHITE

**KT 2073/A**

Complete coaxial left thermostatic kit for radiator connection. Consisting of RCS 2073/A + DCD 29/A. Eurokonus connection.

CODE	SIZE	FINISH						
14832703	DN 15 1/2	CHROME	TR 91/AC	TP 98/C	TP 99/C	557	1	12
14832703CB	DN 15 1/2	WHITE-CHROME	TR 91/AC	TP 98/C	TP 99/C	561	1	12
14832703B	DN 15 1/2	WHITE	TR 91/AC	TP 98/C	TP 99/C	561	1	12

Kit with fittings included.

CODE	SIZE	FINISH			
14010003	DN 15 1/2	CHROME	503	1	12
14010003CB	DN 15 1/2	WHITE-CHROME	507	1	12
14010003B	DN 15 1/2	WHITE	507	1	12

	Fitting	Code	Size
2x	TR 91/AC	67761200C	12 mm
2x	TR 91/AC	67761400C	14 mm
2x	TP 99/C	67861612C	16x2

**MANUAL KIT: CONNECTION FOR COPPER AND PLASTIC PIPE G3/4 EUROKONUS**



CHROME



WHITE-CHROME



WHITE

**KT 59/A**

Complete angle manual kit for radiator connection. Consisting of RS 59/A + DS 79/A. Eurokonus connection.

CODE	SIZE	FINISH						
14622703	DN 15 1/2	CHROME	TR 91/AC	TP 98/C	TP 99/C	502	1	12
14622703CB	DN 15 1/2	WHITE-CHROME	TR 91/AC	TP 98/C	TP 99/C	507	1	12
14622703B	DN 15 1/2	WHITE	TR 91/AC	TP 98/C	TP 99/C	507	1	12

Kit with fittings included.

CODE	SIZE	FINISH			
14010004	DN 15 1/2	CHROME	503	1	12
14010004CB	DN 15 1/2	WHITE-CHROME	507	1	12
14010004B	DN 15 1/2	WHITE	507	1	12

	Fitting	Code	Size
2x	TR 91/AC	67761200C	12 mm
2x	TR 91/AC	67761400C	14 mm
2x	TP 99/C	67861612C	16x2



Fittings for copper pipe



Fittings for plastic pipe



Fittings for multilayer pipe



Fittings: chapter 7



Accessories: chapter 1.A



CHROME



WHITE-CHROME



WHITE

**KT 69/A**

Complete coaxial right manual kit for radiator connection. Consisting of RCD 69/A + DCS 33/A. Eurokonus connection.

CODE	SIZE	FINISH						
14692703	DN 15 1/2	CHROME	TR 91/AC	TP 98/C	TP 99/C	561	1	12
14692703CB	DN 15 1/2	WHITE-CHROME	TR 91/AC	TP 98/C	TP 99/C	564	1	12
14692703B	DN 15 1/2	WHITE	TR 91/AC	TP 98/C	TP 99/C	564	1	12

Kit with fittings included.

CODE	SIZE	FINISH			
14010005	DN 15 1/2	CHROME	503	1	12
14010005CB	DN 15 1/2	WHITE-CHROME	507	1	12
14010005B	DN 15 1/2	WHITE	507	1	12

	Fitting	Code	Size
2x	TR 91/AC	67761200C	12 mm
2x	TR 91/AC	67761400C	14 mm
2x	TP 99/C	67861612C	16x2



CHROME



WHITE-CHROME



WHITE

**KT 73/A**

Complete coaxial left manual kit for radiator connection. Consisting of RCS 73/A + DCD 29/A. Eurokonus connection.

CODE	SIZE	FINISH						
14712703	DN 15 1/2	CHROME	TR 91/AC	TP 98/C	TP 99/C	561	1	12
14712703CB	DN 15 1/2	WHITE-CHROME	TR 91/AC	TP 98/C	TP 99/C	564	1	12
14712703B	DN 15 1/2	WHITE	TR 91/AC	TP 98/C	TP 99/C	564	1	12

Kit with fittings included.

CODE	SIZE	FINISH			
14010006	DN 15 1/2	CHROME	503	1	12
14010006CB	DN 15 1/2	WHITE-CHROME	507	1	12
14010006B	DN 15 1/2	WHITE	507	1	12

	Fitting	Code	Size
2x	TR 91/AC	67761200C	12 mm
2x	TR 91/AC	67761400C	14 mm
2x	TP 99/C	67861612C	16x2





CHROME



WHITE-CHROME



WHITE

**KT 58/A**

Complete straight manual kit for radiator connection. Consisting of RD 58/A + DD 78/A. Eurokonus connection.

CODE	SIZE	FINISH						
14822703	DN 15 1/2	CHROME	TR 91/AC	TP 98/C	TP 99/C	566	1	12
14822703CB	DN 15 1/2	WHITE-CHROME	TR 91/AC	TP 98/C	TP 99/C	570	1	12
14822703B	DN 15 1/2	WHITE	TR 91/AC	TP 98/C	TP 99/C	570	1	12

**THERMOSTATISABLE VALVES WITH PRE-REGULATION:  
CONNECTION FOR COPPER AND PLASTIC PIPE G3/4 EUROKONUS**



CHROME



WHITE-CHROME

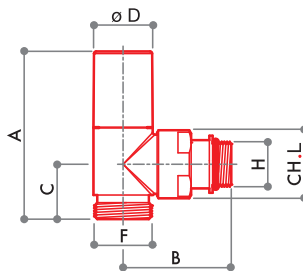

**RS 259/A**

Angle radiator valve thermostatically or electrically controllable with protection cap. Eurokonus connection.

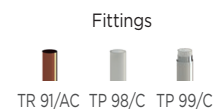

CODE	SIZE	FINISH	A	B	C	D	E	F	G	H	L			
14202703	DN 15 1/2	CHROME	67	50	25	37	-	G 3/4EK	-	G 1/2	28	264	5	60
14202703CB	DN 15 1/2	WHITE-CHROME	67	50	25	37	-	G 3/4EK	-	G 1/2	28	265	5	60



CHROME



WHITE-CHROME

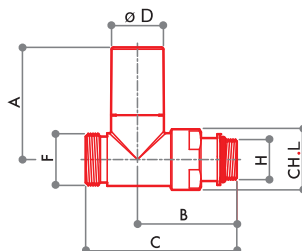

**RD 258/A**

Straight radiator valve thermostatically or electrically controllable with protection cap. Eurokonus connection.

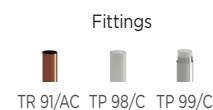

CODE	SIZE	FINISH	A	B	C	D	E	F	G	H	L			
14402703	DN 15 1/2	CHROME	48	51	78	37	-	G 3/4EK	-	G 1/2	28	292	5	60
14402703CB	DN 15 1/2	WHITE-CHROME	48	51	78	37	-	G 3/4EK	-	G 1/2	28	293	5	60



Fittings for copper pipe



Fittings for plastic pipe



Fittings for multilayer pipe



Fittings: chapter 7



Accessories: chapter 1.A



CHROME



WHITE-CHROME

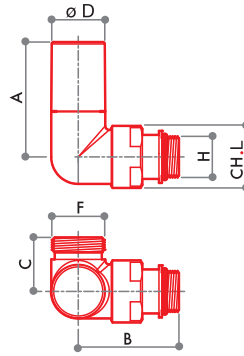

**RCD 269/A**

Coaxial right radiator valve thermostatically or electrically controllable with protection cap. Eurokonus connection.

Fittings



CODE	SIZE	FINISH	A	B	C	D	E	F	G	H	L			
14272703	DN 15 1/2	CHROME	48	51	27	37	-	G3/4EK	-	G1/2	28	287	5	60
14272703CB	DN 15 1/2	WHITE-CHROME	48	51	27	37	-	G3/4EK	-	G1/2	28	289	5	60



CHROME



WHITE-CHROME

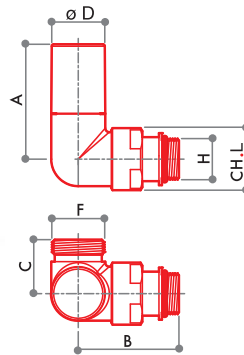

**RCS 273/A**

Coaxial left radiator valve thermostatically or electrically controllable with protection cap. Eurokonus connection.

Fittings



CODE	SIZE	FINISH	A	B	C	D	E	F	G	H	L			
14292703	DN 15 1/2	CHROME	48	51	27	37	-	G3/4EK	-	G1/2	28	287	5	60
14292703CB	DN 15 1/2	WHITE-CHROME	48	51	27	37	-	G3/4EK	-	G1/2	28	289	5	60



CHROME



WHITE-CHROME



WHITE

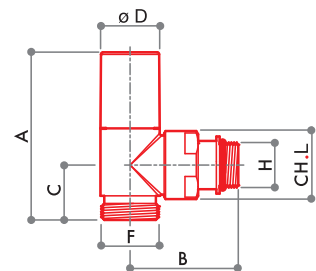

**RS 2059/A**

Angle radiator valve thermostatically or electrically controllable with manual adjustment knob. Eurokonus connection.

Fittings



CODE	SIZE	FINISH	A	B	C	D	E	F	G	H	L			
14242703	DN 15 1/2	CHROME	83	50	25	35	-	G 3/4EK	-	G 1/2	28	278	5	60
14242703CB	DN 15 1/2	WHITE-CHROME	83	50	25	35	-	G 3/4EK	-	G 1/2	28	278	5	60
14242703B	DN 15 1/2	WHITE	83	50	25	35	-	G 3/4EK	-	G 1/2	28	278	5	60



CHROME



WHITE-CHROME



WHITE

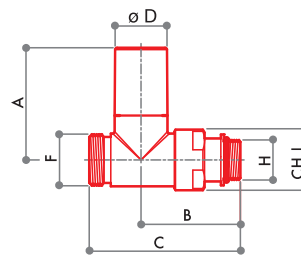

**RD 2058/A**

Straight radiator valve thermostatically or electrically controllable with manual adjustment knob. Eurokonus connection.

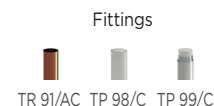

CODE	SIZE	FINISH	A	B	C	D	E	F	G	H	L			
14442703	DN 15 1/2	CHROME	64	51	78	35	-	G 3/4EK	-	G 1/2	28	305	5	60
14442703CB	DN 15 1/2	WHITE-CHROME	64	51	78	35	-	G 3/4EK	-	G 1/2	28	306	5	60
14442703B	DN 15 1/2	WHITE	64	51	78	35	-	G 3/4EK	-	G 1/2	28	306	5	60



CHROME



WHITE-CHROME



WHITE

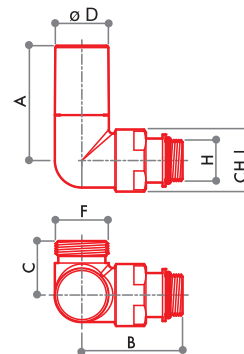

**RCD 2069/A**

Coaxial right radiator valve thermostatically or electrically controllable with manual adjustment knob. Eurokonus connection.

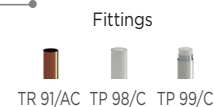

CODE	SIZE	FINISH	A	B	C	D	E	F	G	H	L			
14312703	DN 15 1/2	CHROME	64	51	27	35	-	G3/4EK	-	G1/2	28	300	5	60
14312703CB	DN 15 1/2	WHITE-CHROME	64	51	27	35	-	G3/4EK	-	G1/2	28	303	5	60
14312703B	DN 15 1/2	WHITE	64	51	27	35	-	G3/4EK	-	G1/2	28	303	5	60



CHROME



WHITE-CHROME



WHITE

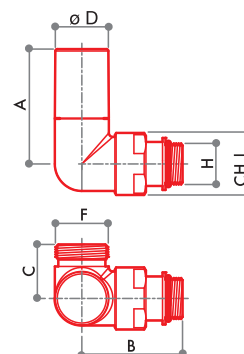

**RCS 2073/A**

Coaxial left radiator valve thermostatically or electrically controllable with manual adjustment knob. Eurokonus connection.

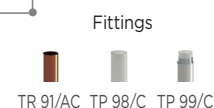

CODE	SIZE	FINISH	A	B	C	D	E	F	G	H	L			
14332703	DN 15 1/2	CHROME	64	51	27	35	-	G3/4EK	-	G1/2	28	300	5	60
14332703CB	DN 15 1/2	WHITE-CHROME	64	51	27	35	-	G3/4EK	-	G1/2	28	303	5	60
14332703B	DN 15 1/2	WHITE	64	51	27	35	-	G3/4EK	-	G1/2	28	303	5	60



Fittings for copper pipe



Fittings for plastic pipe



Fittings for multilayer pipe



Fittings: chapter 7



Accessories: chapter 1.A

**MANUAL VALVES: CONNECTION FOR COPPER AND PLASTIC PIPE G3/4 EUROKONUS**



CHROME



WHITE-CHROME



WHITE

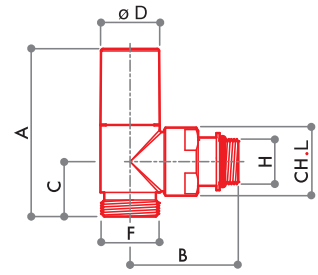

**RS 59/A**

Single adjustment angle radiator valve. Eurokonus connection.

Fittings



CODE	SIZE	FINISH	A	B	C	D	E	F	G	H	L			
14122703	DN 15 1/2	CHROME	77	50	25	27	-	G 3/4EK	-	G 1/2	28	278	5	60
14122703CB	DN 15 1/2	WHITE-CHROME	77	50	25	27	-	G 3/4EK	-	G 1/2	28	278	5	60
14122703B	DN 15 1/2	WHITE	77	50	25	27	-	G 3/4EK	-	G 1/2	28	278	5	60



CHROME



WHITE-CHROME



WHITE

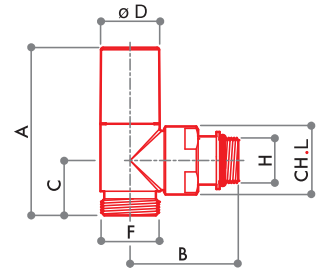

**DS 79/A**

Angle regulating lockshield. Eurokonus connection.

Fittings



CODE	SIZE	FINISH	A	B	C	D	E	F	G	H	L			
14162703	DN 15 1/2	CHROME	62	50	25	27	-	G 3/4EK	-	G 1/2	28	224	5	60
14162703CB	DN 15 1/2	WHITE-CHROME	62	50	25	27	-	G 3/4EK	-	G 1/2	28	229	5	60
14162703B	DN 15 1/2	WHITE	62	50	25	27	-	G 3/4EK	-	G 1/2	28	229	5	60



CHROME



WHITE-CHROME



WHITE

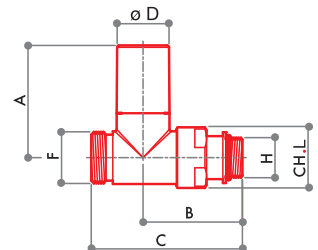

**RD 58/A**

Single adjustment straight radiator valve. Eurokonus connection.

Fittings



CODE	SIZE	FINISH	A	B	C	D	E	F	G	H	L			
14322703	DN 15 1/2	CHROME	58	51	78	27	-	G 3/4EK	-	G 1/2	28	305	5	60
14322703CB	DN 15 1/2	WHITE-CHROME	58	51	78	27	-	G 3/4EK	-	G 1/2	28	309	5	60
14322703B	DN 15 1/2	WHITE	58	51	78	27	-	G 3/4EK	-	G 1/2	28	309	5	60



CHROME



WHITE-CHROME



WHITE

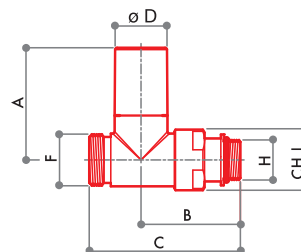

**DD 78/A**

Straight regulating lockshield. Eurokonus connection.

Fittings



CODE	SIZE	FINISH	A	B	C	D	E	F	G	H	L			
14362703	DN 15 1/2	CHROME	42	51	78	27	-	G 3/4EK	-	G 1/2	28	260	5	60
14362703CB	DN 15 1/2	WHITE-CHROME	42	51	78	27	-	G 3/4EK	-	G 1/2	28	567	5	60
14362703B	DN 15 1/2	WHITE	42	51	78	27	-	G 3/4EK	-	G 1/2	28	567	5	60



CHROME



WHITE-CHROME



WHITE

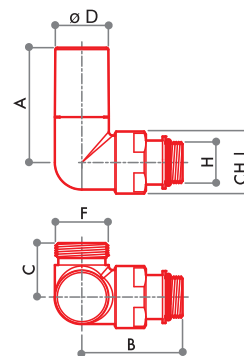

**RCD 69/A**

Single adjustment coaxial right radiator valve. Eurokonus connection.

Fittings



CODE	SIZE	FINISH	A	B	C	D	E	F	G	H	L			
14192703	DN 15 1/2	CHROME	58	51	27	27	-	G3/4EK	-	G1/2	28	304	5	60
14192703CB	DN 15 1/2	WHITE-CHROME	58	51	27	27	-	G3/4EK	-	G1/2	28	306	5	60
14192703B	DN 15 1/2	WHITE	58	51	27	27	-	G3/4EK	-	G1/2	28	306	5	60



CHROME



WHITE-CHROME



WHITE

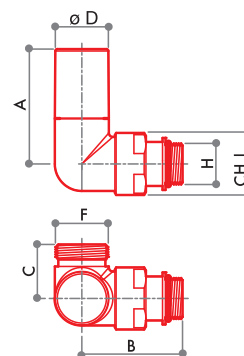

**DCS 33/A**

Single adjustment coaxial left regulating lockshield. Eurokonus connection.

Fittings



CODE	SIZE	FINISH	A	B	C	D	E	F	G	H	L			
14252703	DN 15 1/2	CHROME	42	51	27	27	-	G3/4EK	-	G1/2	28	258	5	60
14252703CB	DN 15 1/2	WHITE-CHROME	42	51	27	27	-	G3/4EK	-	G1/2	28	258	5	60
14252703B	DN 15 1/2	WHITE	42	51	27	27	-	G3/4EK	-	G1/2	28	258	5	60



Fittings for copper pipe



Fittings for plastic pipe



Fittings for multilayer pipe



Fittings: chapter 7



Accessories: chapter 1.A



CHROME



WHITE-CHROME



WHITE

**RCS 73/A**

Single adjustment coaxial left radiator valve. Eurokonus connection.

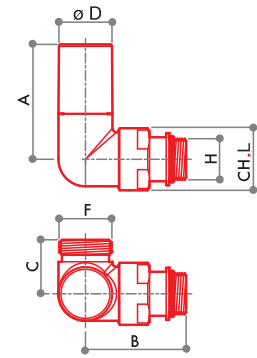

Fittings



CODE	SIZE	FINISH	A	B	C	D	E	F	G	H	L			
14212703	DN 15 1/2	CHROME	58	51	27	27	-	G3/4EK	-	G1/2	28	304	5	60
14212703CB	DN 15 1/2	WHITE-CHROME	58	51	27	27	-	G3/4EK	-	G1/2	28	306	5	60
14212703B	DN 15 1/2	WHITE	58	51	27	27	-	G3/4EK	-	G1/2	28	306	5	60



CHROME



WHITE-CHROME



WHITE

**DCD 29/A**

Single adjustment coaxial right regulating lockshield. Eurokonus connection.

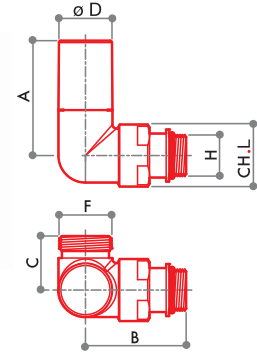

Fittings



CODE	SIZE	FINISH	A	B	C	D	E	F	G	H	L			
14232703	DN 15 1/2	CHROME	42	51	27	27	-	G3/4EK	-	G1/2	28	258	5	60
14232703CB	DN 15 1/2	WHITE-CHROME	42	51	27	27	-	G3/4EK	-	G1/2	28	258	5	60
14232703B	DN 15 1/2	WHITE	42	51	27	27	-	G3/4EK	-	G1/2	28	258	5	60

**SINGLE/DOUBLE PIPE VALVES**

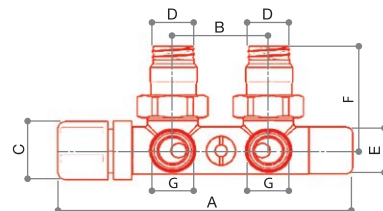
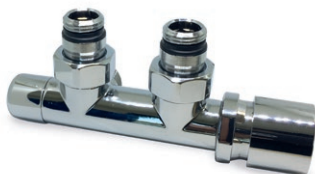

**MT 2590/A**

Single/double pipe thermostatic valve with manual adjustment knob. Adjustable bypass valve. Eurokonus connection.

Fittings



CODE	SIZE	FINISH	A	B	C	D	E	F	G			
14002703	DN 15 1/2	CHROME	153	50	34	G1/2	26	52	G3/4EK	657	1	10



# TT 3000C

## THERMOSTATIC HEAD



### TECHNICAL DATA



Max temperature  
120 °C



Max pressure  
10 bar



Max differential pressure  
0,6 bar

**Min. adjustment temperature (anti-freeze pos.)**

Ts min 6 °C

**Max regulation temperature (max position)**

Ts max 30 °C (5)

**Energy saving conditions**

20 °C

**Thermostatic element inalterability range**

-15 °C ÷ 60 °C

**Storage temperature**

-20 °C ÷ + 50 °C

**Hysteresis**

C 0,4 k

**Differential pressure influence**

D 0,5 k

**Water temperature influence**

W 0,25 k

**Response time**

Z 22 min.

**Control Accuracy**

CA 0,2 K.

### VALVE CONNECTION



M 30 x 1,5

**FOR MORE INFORMATION  
PLEASE REFER TO CHAPTER  
THERMOTEKNA**

### CONSTRUCTIVE FEATURES

Thermostatic heads consist of a sensor filled with a highly expandable element. This element, which may be incorporated in the adjustment knob or in the remote sensor, expands or contracts in proportion to room temperature changes, reacting even to the smallest variation. When the surrounding

temperature increases, the element expands and acts on the obturator with an axial thrust movement, thus controlling the valve action. The flow of the heating medium can be adjusted by opening and closing the valve.

### THERMOSTATIC HEAD WITH INTEGRATED CONTROL AND SENSOR



CHROME



WHITE-CHROME

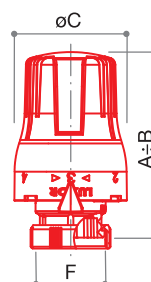

**TT 3000**

Thermostatic head with integrated control and sensor.

CODE	SIZE	FINISH	A	B	C	D	E	F	G	H	L			
69100000C	M30x1,5	CHROME	75	80	46,5	-	-	M30x1,5	-	-	-	110	1	100
69100000CB	M30x1,5	WHITE-CHROME	75	80	46,5	-	-	M30x1,5	-	-	-	110	1	100

VALVES FLOW RATE CHART

MANUAL VALVE

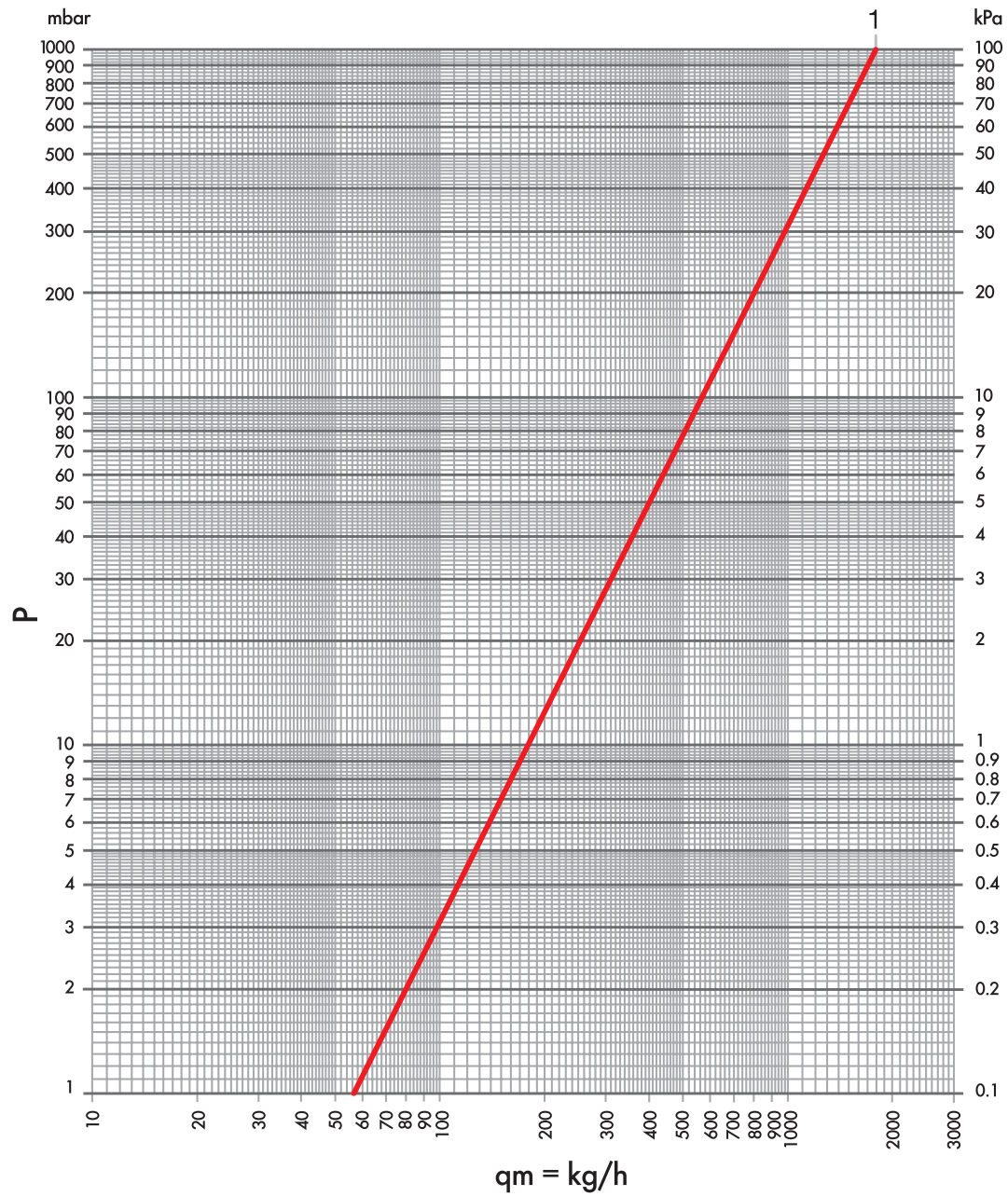

ITEM	LOOP N°	Kv	POS
RD 58/A 1/2 RS 59/A 1/2 RCD 69/A 1/2 RCS 73/A 1/2	1	1,85	1

VALVES FLOW RATE CHART

THERMO VALVES

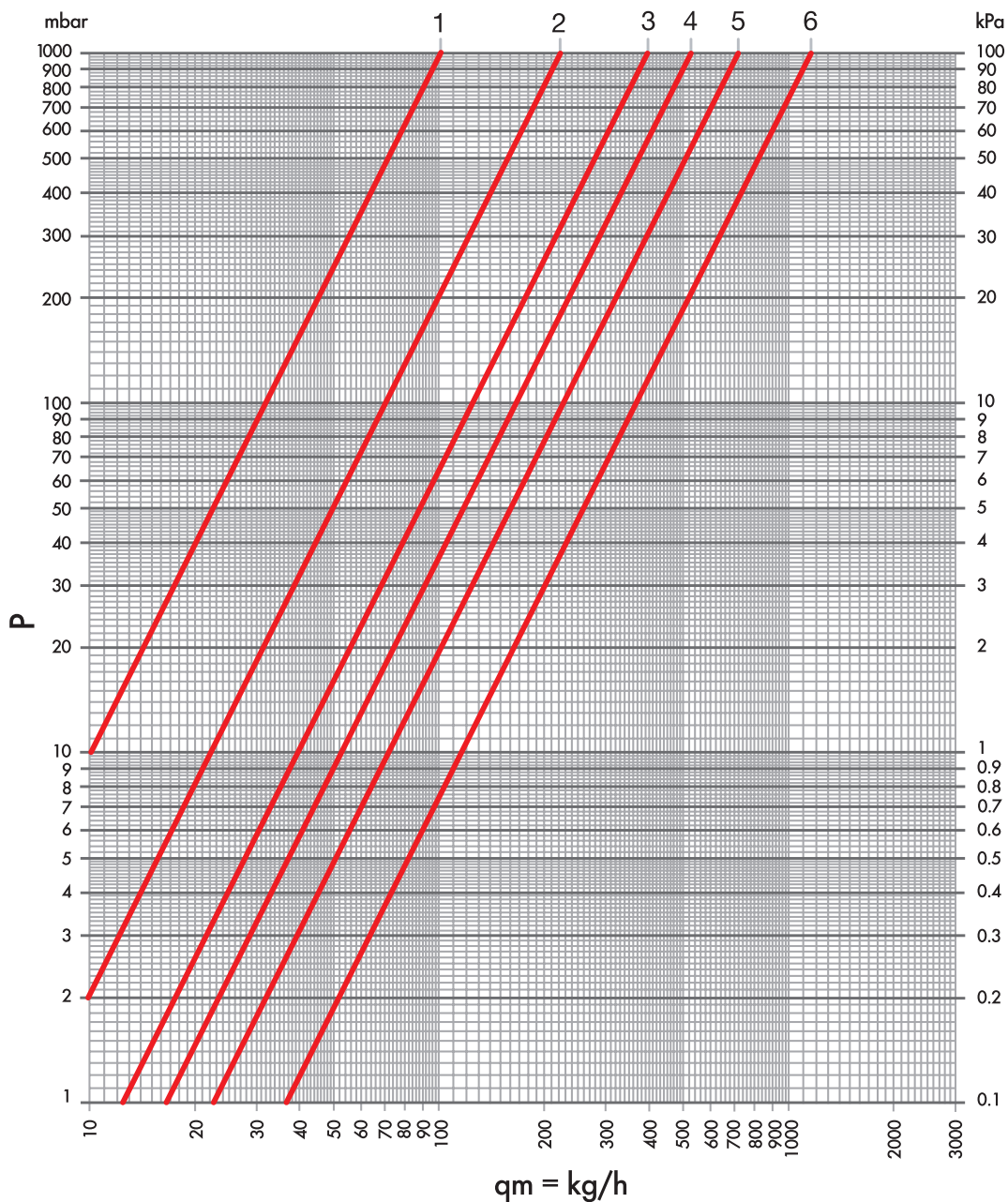

ITEM	Kv	Kv Δt 1 °C	Kv Δt 2 °C	POS
RD 258/A RS 259/A RCD 269/A RCS 273/A RD 2058/A RS 2059/A RCD 2069/A RCS 2073/A	0,10	0,11	0,15	1
	0,22	0,16	0,25	2
	0,39	0,18	0,36	3
	0,52	0,18	0,37	4
	0,71	0,19	0,43	5
	1,25	0,20	0,50	6

### LOCKSHIELD FLOW RATE CHART

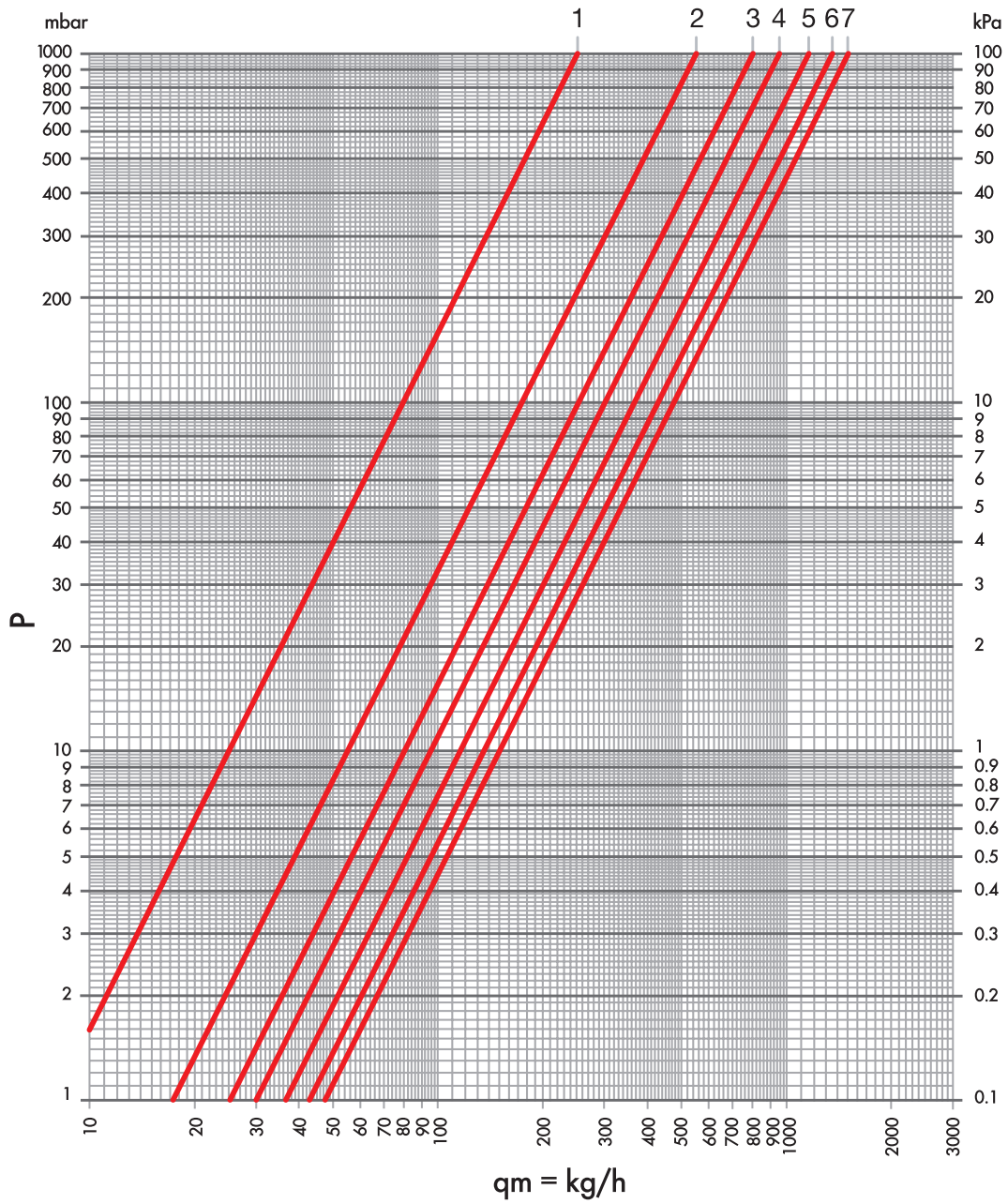

ITEM	LOOP N°	Kv	POS
DD 78/A DS 79/A DCD 29/A DCS 33/A	1	0,25	1
	1+1/2	0,55	2
	2	0,80	3
	2+1/2	0,95	4
	3	1,15	5
	3+1/2	1,35	6
	all open	1,50	7