



RADIATOR VALVES

1.3 / SERIES 30

SERIES 30 RADIATOR VALVES



The screw of Serie 30 valves allows to preset the flow thanks to a shaped acetal ring. The thermostatic screw enables to replace one of the o-rings on the control stem without draining the system. The valves are chrome plated.



The tightness of Serie 30 lockshields is ensured by an o-ring on the obturator and, if necessary, by a further o-ring between the body and the plug. When in closed position, the tightness is granted by an o-ring and a conical metal collar. The lockshields are chrome plated. All lockshields allow for flow adjustment by limiting the lift of the obturator.



The Serie 30 manual valve features a fixed stem, whose tightness is ensured by two o-rings. When in closed position, the tightness is granted by an o-ring and a conical metal collar. The valves are chrome plated.

TECHNICAL DATA



DN

15



Max temperature

120 °C



Max pressure

10 bar



Max differential pressure (thermostatic valves)

0,6 bar



Max differential pressure

1 bar



Materials

CW617N
UNI EN
12165:2016



Knob

Plated ABS
white ABS
RAL 9016



Stem

AISI 316



Testing

100%

SYSTEM CONNECTIONS



Iron pipe
(manual valves)
G 1/2

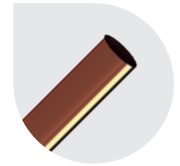

Copper pipe
G 3/4 EK - TR 91/AC



Plastic pipe
G 3/4 EK - TP 98/C



Multilayer pipe
G 3/4 EK - TP 99/C

RADIATOR CONNECTION



Cylindrical thread with soft sealing
G 1/2

FLOW ADJUSTMENT AND REVERSE FLOW

To adjust the maximum flow rate, proceed as follows:

- align the reference mark on the stainless steel stem with one of the positions marked on the valve.

Luxor thermostatic valves are now EN 215 approved in reverse flow mode as well.

This characteristic allows for installation on the inlet as well as on the outlet of the radiator up to a 0,6 bar differential pressure.

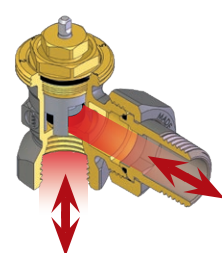
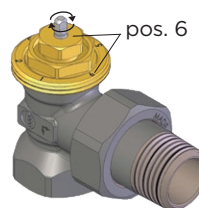
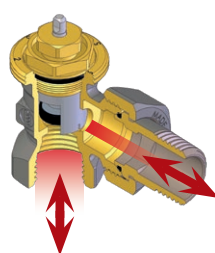
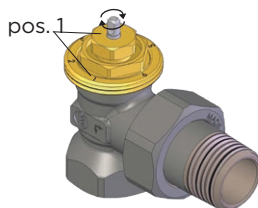

All valves and lockshields are 100% checked with an electronically controlled pneumatic test.

The characteristics of the fluid in the system must be compliant with the UNI 8065: 2019 directive.

CONNECTION FOR IRON PIPE



CHROME



WHITE-CHROME

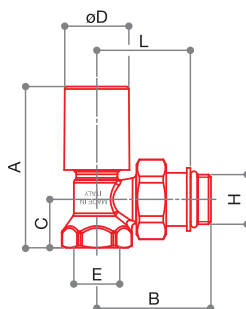

KT 146

Complete angle manual kit for radiator connection. Consisting of two RS 146. Connection for iron pipe.

Fittings



CODE	SIZE	FINISH	A	B	C	D	E	F	G	H	L			
20822103	DN 15 1/2	CHROME	67	47	20	27	G 1/2	-	-	G 1/2	39	343	1	32
20822103CB	DN 15 1/2	WHITE-CHROME	67	47	20	27	G 1/2	-	-	G 1/2	39	343	1	32

CONNECTION FOR PLASTIC PIPE G 3/4 EUROKONUS.



CHROME



WHITE-CHROME

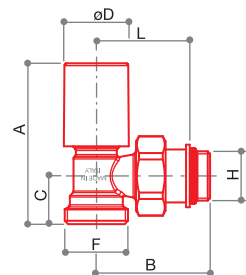

KT 159/A

Complete angle manual kit for radiator connection. Consisting of two RS 159/A. Connection G 3/4 eurokonus.

Fittings



CODE	SIZE	FINISH	A	B	C	D	E	F	G	H	L			
20842703	DN 15 1/2	CHROME	67	47	20	27	-	G 3/4 EK	-	G 1/2	39	340	1	32
20842703CB	DN 15 1/2	WHITE-CHROME	67	47	20	27	-	G 3/4 EK	-	G 1/2	39	340	1	32



CHROME



WHITE-CHROME

KT 2509/A

Complete angle thermostatic kit for radiator connection. Consisting of RS 2009/A + DS 89/A. Connection G 3/4 eurokonus.

Fittings



CODE	SIZE	FINISH			
20742703	DN 15 1/2	CHROME	380	1	32
20742703CB	DN 15 1/2	WHITE-CHROME	380	1	32



CHROME



WHITE-CHROME

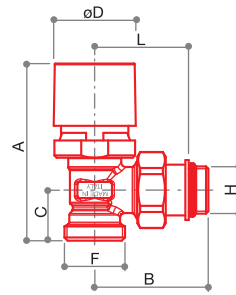

RS 2509/A

Angle radiator valve thermostatically or electrically controllable with manual adjustment knob. Connection G 3/4 eurokonus.

Fittings



CODE	SIZE	FINISH	A	B	C	D	E	F	G	H	L			
20722703	DN 15 1/2	CHROME	77	49	22	36	-	G 3/4 EK	-	G 1/2	41	203	10	80
20722703CB	DN 15 1/2	WHITE-CHROME	77	49	22	36	-	G 3/4 EK	-	G 1/2	41	203	10	80



CHROME



WHITE-CHROME

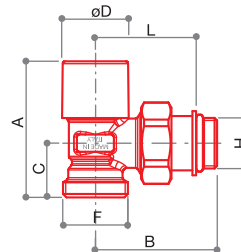

DS 89/A

Angle regulating lockshield. Connection G 3/4 eurokonus.

Fittings



CODE	SIZE	FINISH	A	B	C	D	E	F	G	H	L			
20162703	DN 15 1/2	CHROME	55	49	22	27	-	G 3/4 EK	-	G 1/2	41	168	10	80
20162703CB	DN 15 1/2	WHITE-CHROME	55	49	22	27	-	G 3/4 EK	-	G 1/2	41	168	10	80

VALVES FLOW RATE CHART

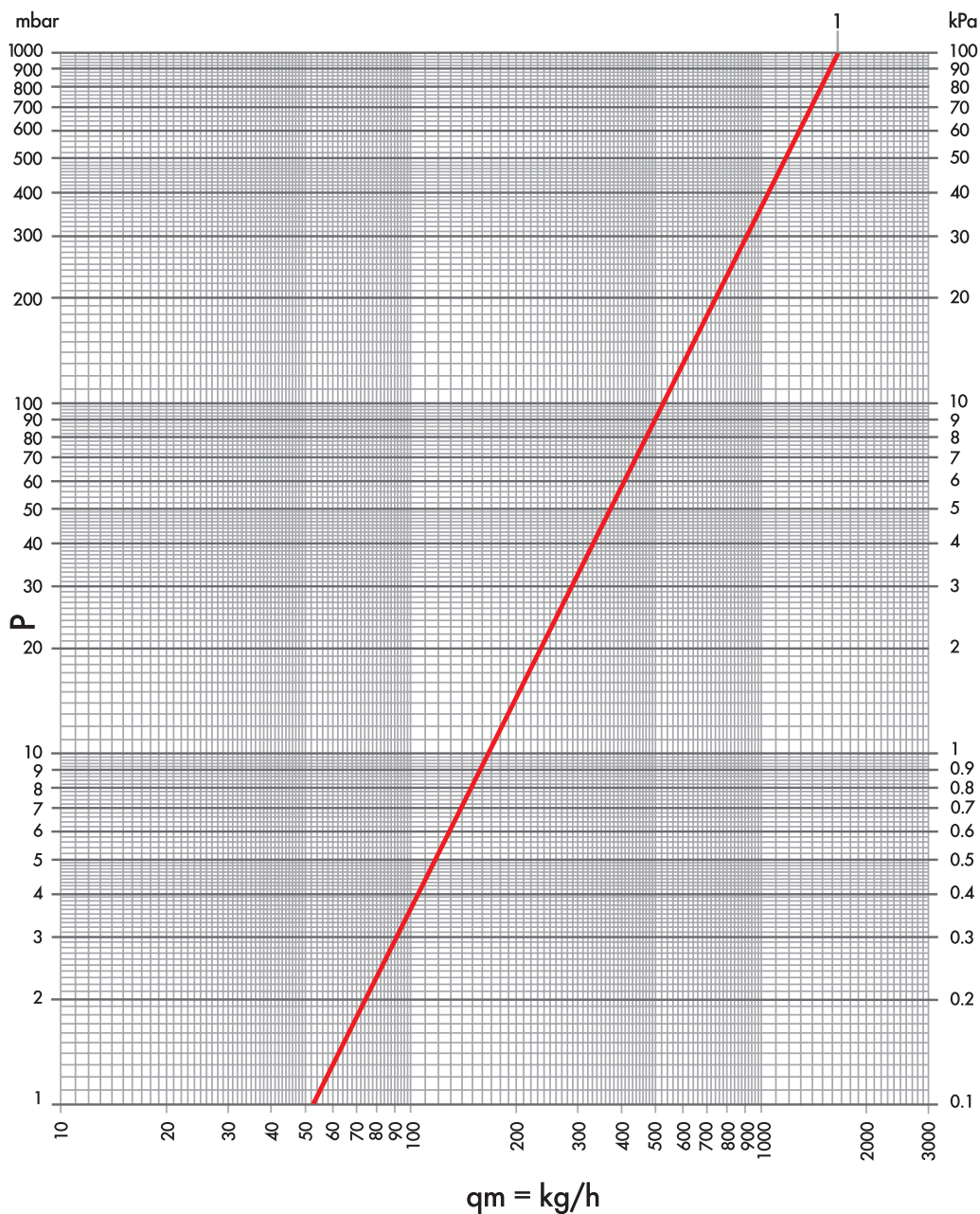

ITEM	Kv	POS
RS 159/A 1/2	1,65	1

VALVES FLOW RATE CHART

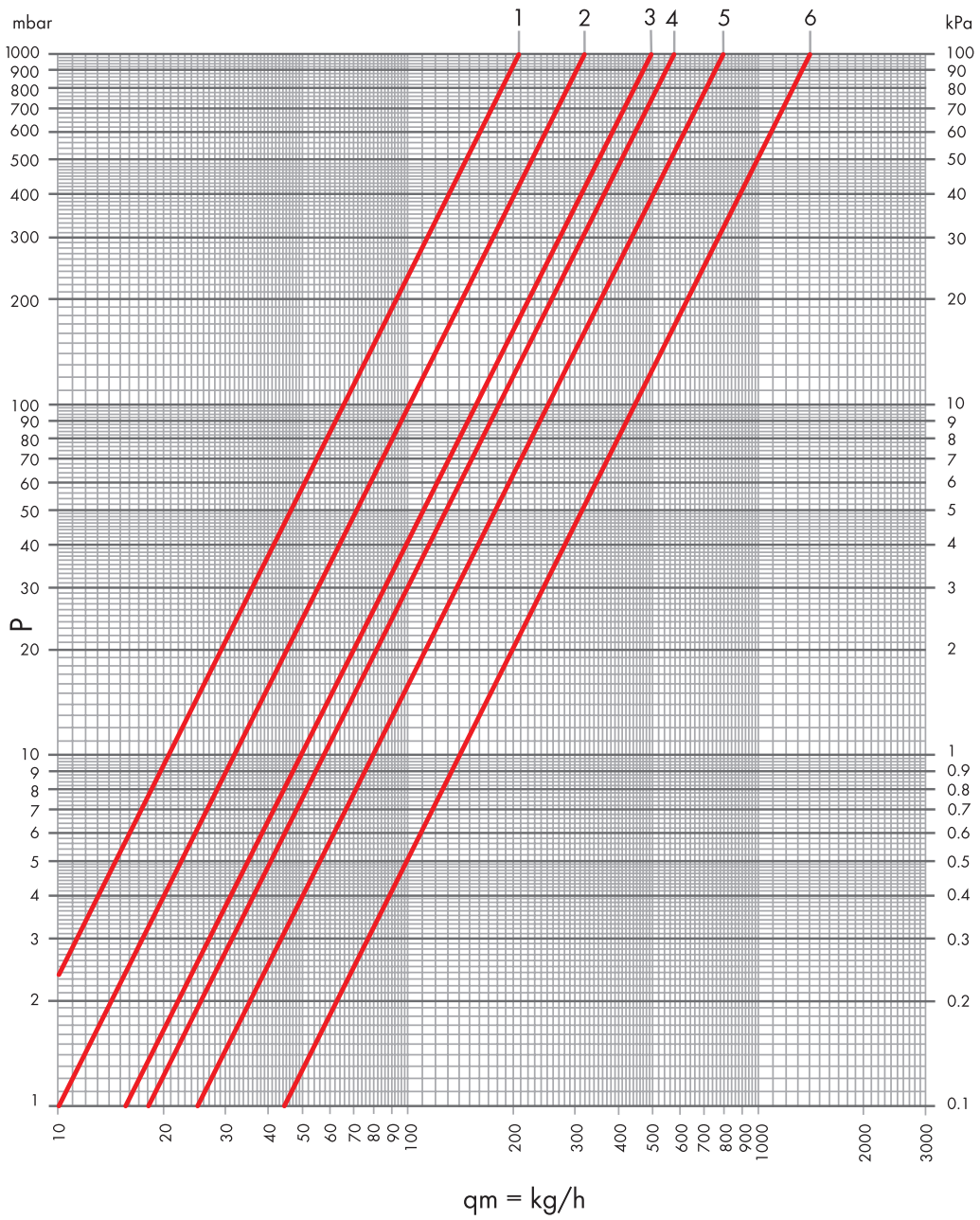

ITEM	Kv	Kv Δt 1 °C	Kv Δt 2 °C	POS
RS 2509/A	0,10	0,07	0,07	1
	0,32	0,2	0,25	2
	0,49	0,24	0,36	3
	0,57	0,24	0,37	4
	0,79	0,24	0,40	5
	1,39	0,32	0,55	6

LOCKSHIELD FLOW RATE CHART

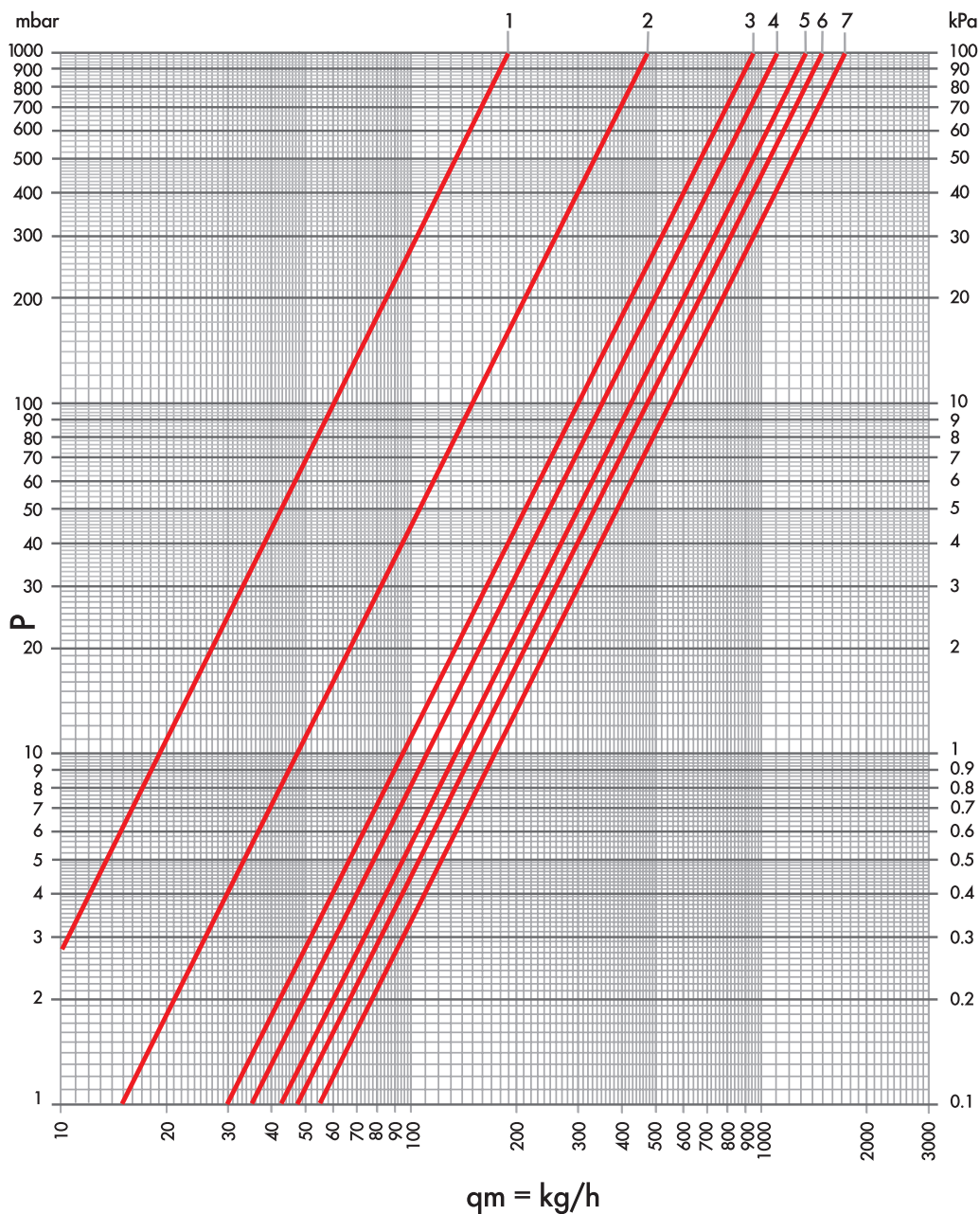

ITEM	LOOP N°	Kv	POS
DS 89/A	1	0,19	1
	1+1/2	0,48	2
	2	0,71	3
	2+1/2	0,92	4
	3	1,06	5
	3+1/2	1,18	6
	all open	1,29	7



25 horizontal lines for writing or drawing.