



60 YEARS OF ITALIAN TRADITION

Luxor is an important industrial reality, world wide and European market leader in the production of flexible hoses and components for hydro and thermo-sanitary installations. Luxor has been the expression of the most prestigious made in Italy and the great Italian high technology mechanical workings tradition for fifty years; a quality certified and recognized by the most prestigious International Certification Institutes all over the world.

Our mission is the complete customer satisfaction through a process of continuous technological research in order to make high quality, reliable products, anticipating the market evolutions by innovative partnership with both customers and suppliers. Luxor mission takes

place in its own Research and Development Centre in which new and advanced technologies are constantly analyzed and researched with continuous investments to offer the most innovative and reliable solutions for the international markets at competitive costs, ensuring strict quality controls on each single piece.

Luxor entirely plans and realizes each product, thanks to its decennial know how. The great production strength, a "slender" innovative and advanced industrial organization together with a modern logistic conception, make Luxor able to satisfy every kind of request, even customized, with fast deliveries all over the world.



Luxor is certified
ISO 9001:2015
by DEKRA Group
certification body

CERTIFICATION



Please contact our offices for information about technical specifications and certified products or visit the website of the corresponding certification body for the latter.

Please refer to www.nsf.org for a complete list of NSF approved products.
Please refer to www.iapmort.org for a complete list of UPC/CUPC approved products.



5 / UNDERSINK PIPE CONNECTIONS

UNDERSINK PIPE CONNECTIONS



TECHNICAL DATA



Max temperature

90 °C



Max pressure

10 bar

CONSTRUCTIVE FEATURES

The undersink connections offer the quality and guarantee of a Made in Italy Product. The range of products includes several copper chromed pipes, adjustable elbow, thanks to the articulated slip-off connection with variable lengths, all the technical solutions which make Luxor's undersink connections the ideal solution for any type of installation.

RANGE

All the range is produced with frame chrome plating finish, which guarantees a thicker cover and consequently a higher resistance to ageing and corrosion, next to a top level aesthetic finish. This process is carried out employing material and galvanic processes in compliance to the most severe international rules regulating health and environmental safety.

PIPES

The connection pipes are produced with phosphorous deoxidated copper Cu-DHP with chemical composition Cu 99,9% minimum, whose mechanical features, sizes and tolerances are in compliance to the EN1057 rules and its related regulation. The pipes are polished during the cutting process in order to offer a better quality, and they have a double binding which guarantees a higher resistance during the assembly process and assures the complete removal of the burr and sharp edges which are the causes of possible leakages. All the pieces are carefully washed in ultrasonic tank with neutral agents which remove any possible tailings substances.

ELBOWS AND CONNECTIONS

The elbows and connections in brass CW617N and CW614N are with low lead content in compliance to the recent rules UNI EN12165 and UNI EN12164.

WALL COVERS

The wall covers are in stainless steel AISI 430 weatherproof, resisting to the alkaline of organic acids and solutions and oxidation up to high temperatures.

The tightness are guaranteed by flat gaskets in peroxide EPDM and by clamping cartridges suitable for the use with drinking water.



RCC CARTRIDGE

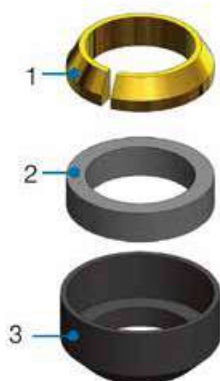

The RCC cartridge is the most safe and functional solution for the connection of taps to the appliances. Being these three parts in one single body the RCC cartridge is the final solution of the problems of installation of the compression fittings. No more parts lost or wrongly assembled, but one single piece which guarantees an excellent mechanic and hydraulic tightness.

1. Tightening washer in brass CW614N

The brass washer has high mechanical qualities thanks to the annealing process which improves the quality of the material giving max guarantee of a good coupling between the fitting and the pipe without having to apply an excessive clamping strength.

2. Internal gasket in NBR

Range of use for temperature up to 90°C: the gaskets in NBR have good mechanical qualities, low strain and low gas permeability.

3. External cartridge in Nylon (Poliamyde 6.6)

Range of use for temperature up to 90°C: the cartridge in Nylon has good mechanical qualities together with high tightness and is shock proof.

ASSEMBLY INSTRUCTIONS



Attention

- Check the correct direction of the cartridge
- Clamping couple suggested from 25 to 30 Nm max.

For a correct assembly of the undersink connection please follow the above steps, checking carefully the direction of the as-

sembly of the cartridge and the gaskets.

It is important to first connect the nipple with wall cover to the water distribution net, correctly insert the gaskets between the elbow and the nipple, insert the RCC cartridge within the clamping nut paying attention to the direction of insertion and finally block the fitting to the pipe.

CHROMED COPPER PIPES

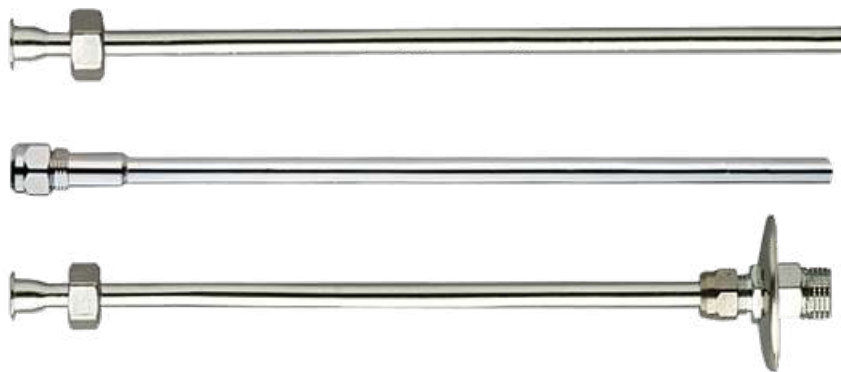

Luxor SpA chrome plated copper pipes are used to connect taps or mixers to the water distribution net.

They are specially used where the under sink connectors are visible and a high aesthetic impact is required.

Furthermore, their usage is also suggested where connection lengths are undefined, leaving the installer the possibility of adapting the pipe to the most adequate situation.

Applications:

- Washbasins with visible connections, without coverings
- Bidet with visible connections, without coverings
- Special size customized applications

- Washbasin with footswitch
- External WC flushing tanks

Chrome plated pipes are made with 99,9% deoxidated copper. The double binding at the endings grants a higher resistance during the assembly process.

Each pipe is deburred, polished and chrome plated obtaining a top level product easy to install and with an excellent aesthetic. The range includes accessories such as compression fittings, adapters and wall covers.



CHROMED COPPER PIPE

Pipe with collar, compression fitting and 3 pcs cartridge.

CODE	FITTINGS	A	B	C	D	E	F	G	H	L			
05060125CC	M 3/8 - F 3/8	14	10	17	19	19	G 3/8	G 3/8	-	250	107	-	20
05060130CC		14	10	17	19	19	G 3/8	G 3/8	-	300	116	-	20
05060135CC		14	10	17	19	19	G 3/8	G 3/8	-	350	125	-	20
05060140CC		14	10	17	19	19	G 3/8	G 3/8	-	400	134	10	-
05060150CC		14	10	17	19	19	G 3/8	G 3/8	-	500	152	10	-
05060170CC		14	10	17	19	19	G 3/8	G 3/8	-	700	188	10	-
05060199CC		14	10	17	19	19	G 3/8	G 3/8	-	1000	242	10	-

05060225CC	M 3/8 - F 1/2	18	10	17	19	23	G 3/8	G 1/2	-	250	109	-	20
05060230CC		18	10	17	19	23	G 3/8	G 1/2	-	300	118	-	20
05060235CC		18	10	17	19	23	G 3/8	G 1/2	-	350	127	-	20
05060240CC		18	10	17	19	23	G 3/8	G 1/2	-	400	136	10	-
05060250CC		18	10	17	19	23	G 3/8	G 1/2	-	500	154	10	-
05060270CC		18	10	17	19	23	G 3/8	G 1/2	-	700	190	10	-
05060299CC		18	10	17	19	23	G 3/8	G 1/2	-	1000	244	10	-

05060325CC	M 1/2 - F 3/8	14	10	21	19	19	G 1/2	G 3/8	-	250	114	-	20
05060330CC		14	10	21	19	19	G 1/2	G 3/8	-	300	123	-	20
05060335CC		14	10	21	19	19	G 1/2	G 3/8	-	350	132	-	20
05060340CC		14	10	21	19	19	G 1/2	G 3/8	-	400	141	10	-
05060350CC		14	10	21	19	19	G 1/2	G 3/8	-	500	159	10	-
05060370CC		14	10	21	19	19	G 1/2	G 3/8	-	700	195	10	-
05060399CC		14	10	21	19	19	G 1/2	G 3/8	-	1000	249	10	-

05060425CC	M 1/2 - F 1/2	18	10	21	19	23	G 1/2	G 1/2	-	250	116	-	20
05060430CC		18	10	21	19	23	G 1/2	G 1/2	-	300	125	-	20
05060435CC		18	10	21	19	23	G 1/2	G 1/2	-	350	136	-	20
05060440CC		18	10	21	19	23	G 1/2	G 1/2	-	400	143	10	-
05060450CC		18	10	21	19	23	G 1/2	G 1/2	-	500	161	10	-
05060470CC		18	10	21	19	23	G 1/2	G 1/2	-	700	197	10	-
05060499CC		18	10	21	19	23	G 1/2	G 1/2	-	1000	251	10	-



CHROMED COPPER PIPE

Pipe with collar, compression fitting, 3 pcs cartridge long male connection and sliding wall cover.

CODE	FITTINGS	A	B	C	D	E	F	G	H	L			
05070125CC	MPR 3/8 - F 3/8	14	10	17	19	19	G 3/8	G 3/8	60	250	125	-	20
05070130CC		14	10	17	19	19	G 3/8	G 3/8	60	300	134	-	20
05070135CC		14	10	17	19	19	G 3/8	G 3/8	60	350	143	-	20
05070140CC		14	10	17	19	19	G 3/8	G 3/8	60	400	152	10	-
05070150CC		14	10	17	19	19	G 3/8	G 3/8	60	500	170	10	-
05070170CC		14	10	17	19	19	G 3/8	G 3/8	60	700	206	10	-
05070199CC		14	10	17	19	19	G 3/8	G 3/8	60	1000	260	10	-

05070225CC	MPR 3/8 - F 1/2	18	10	17	19	23	G 3/8	G 1/2	60	250	127	-	20
05070230CC		18	10	17	19	23	G 3/8	G 1/2	60	300	136	-	20
05070235CC		18	10	17	19	23	G 3/8	G 1/2	60	350	145	-	20
05070240CC		18	10	17	19	23	G 3/8	G 1/2	60	400	154	10	-
05070250CC		18	10	17	19	23	G 3/8	G 1/2	60	500	172	10	-
05070270CC		18	10	17	19	23	G 3/8	G 1/2	60	700	208	10	-
05070299CC		18	10	17	19	23	G 3/8	G 1/2	60	1000	262	10	-

05070325CC	MPR 1/2 - F 3/8	14	10	21	19	19	G 1/2	G 3/8	60	250	135	-	20
05070330CC		14	10	21	19	19	G 1/2	G 3/8	60	300	144	-	20
05070335CC		14	10	21	19	19	G 1/2	G 3/8	60	350	153	-	20
05070340CC		14	10	21	19	19	G 1/2	G 3/8	60	400	162	10	-
05070350CC		14	10	21	19	19	G 1/2	G 3/8	60	500	180	10	-
05070370CC		14	10	21	19	19	G 1/2	G 3/8	60	700	216	10	-
05070399CC		14	10	21	19	19	G 1/2	G 3/8	60	1000	270	10	-

05070425CC	MPR 1/2 - F 1/2	18	10	21	19	23	G 1/2	G 1/2	60	250	137	-	20
05070430CC		18	10	21	19	23	G 1/2	G 1/2	60	300	146	-	20
05070435CC		18	10	21	19	23	G 1/2	G 1/2	60	350	155	-	20
05070440CC		18	10	21	19	23	G 1/2	G 1/2	60	400	164	10	-
05070450CC		18	10	21	19	23	G 1/2	G 1/2	60	500	182	10	-
05070470CC		18	10	21	19	23	G 1/2	G 1/2	60	700	218	10	-
05070499CC		18	10	21	19	23	G 1/2	G 1/2	60	1000	272	10	-



ANNALED CHROMED COPPER PIPE

Straight pipe without collar.

CODE	FITTINGS	A	B	C	D	E	F	G	H	L			
05421000	Ø 10	-	10	-	-	-	-	-	-	1000	200	10	-
05421200	Ø 12	-	12	-	-	-	-	-	-	1000	222	10	-
05421400	Ø 14	-	14	-	-	-	-	-	-	1000	258	10	-

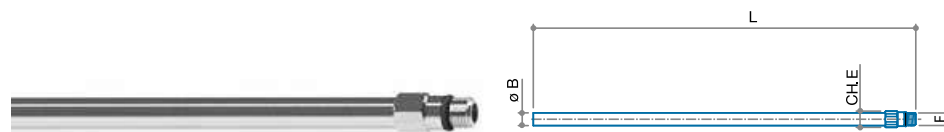

COPPER PIPE

Chromed pipe with male fitting.

CODE	FITTINGS	A	B	C	D	E	F	G	H	L			
05012230	Ø 10 - M 10 x 1	-	10	-	-	12	M 10 x 1	-	-	300	66	10	-
05012240		-	10	-	-	12	M 10 x 1	-	-	400	87	10	-
05012260		-	10	-	-	12	M 10 x 1	-	-	600	126	10	-

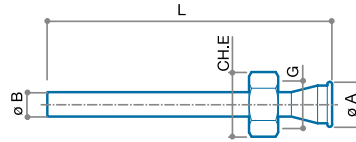

CHROMED COPPER PIPE

Pipe with collar and nut.

CODE	FITTINGS	A	B	C	D	E	F	G	H	L			
05051720	Ø 10 - F 3/8	14	10	-	-	19	-	G 3/8	-	200	53	10	50
05051725		14	10	-	-	19	-	G 3/8	-	250	62	10	50
05051730		14	10	-	-	19	-	G 3/8	-	300	71	10	50
05051735		14	10	-	-	19	-	G 3/8	-	350	80	10	50
05051740		14	10	-	-	19	-	G 3/8	-	400	89	10	-
05051750		14	10	-	-	19	-	G 3/8	-	500	107	10	-
05051770		14	10	-	-	19	-	G 3/8	-	700	143	10	-
05051799		14	10	-	-	19	-	G 3/8	-	1000	197	10	-

05052120	Ø 10 - F 1/2	18	10	-	-	23	-	G 1/2	-	200	55	10	50
05052125		18	10	-	-	23	-	G 1/2	-	250	64	10	50
05052130		18	10	-	-	23	-	G 1/2	-	300	73	10	50
05052135		18	10	-	-	23	-	G 1/2	-	350	82	10	50
05052140		18	10	-	-	23	-	G 1/2	-	400	91	10	-
05052150		18	10	-	-	23	-	G 1/2	-	500	109	10	-
05052170		18	10	-	-	23	-	G 1/2	-	700	145	10	-
05052199		18	10	-	-	23	-	G 1/2	-	1000	199	10	-

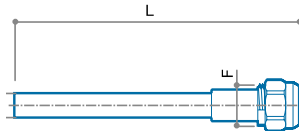

ANNEALED CHROMED COPPER PIPE

Pipe with compression fitting and 3 pcs cartridge.

CODE	FITTINGS	A	B	C	D	E	F	G	H	L			
05100030CC	Ø 10 - RCC 3/8	-	10	-	-	19	G 3/8	-	-	300	86	10	50

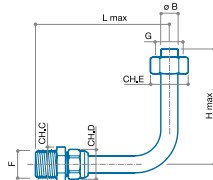

CHROMED COPPER ELBOW

Elbow complete with nipple and compression fitting with 3 pcs cartridge.

CODE	FITTINGS	A	B	C	D	E	F	G	H	L			
05422112	M 1/2 - F 1/2	-	12	21	19	23	G 1/2	G 1/2	20	250	160	2	80
05422114		-	14	21	19	23	G 1/2	G 1/2	20	250	184	2	80

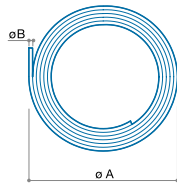

ROLL OF ANNEALED CHROMED PIPE

Pliable copper roll.

CODE	FITTINGS	A	B	C	D	E	F	G	H	L			
05401000	Ø 10	350	10	-	-	-	-	-	-	5000	920	-	1
05401200	Ø 12	350	12	-	-	-	-	-	-	5000	1120	-	1

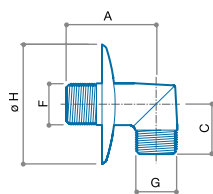

FIXED 90° ELBOW

Chromed brass elbow for shower with sliding chromed copper wall cover.

CODE	FITTINGS	A	B	C	D	E	F	G	H	L			
85620001	M 1/2 - M 1/2	45	-	25	-	-	G 1/2	G 1/2	68	-	50	10	100
85620002	M 1/2 - M 1/2	45	-	25	-	-	G 1/2	G 1/2	55	-	50	25	200

UNDERSINK ELBOW



Adjustable elbows and wall covers are used to facilitate connection between copper pipes and water distribution net. These items are mainly requested for installations where connections remain visible afterwards.

Applications:

- Washbasins with visible connections, without coverings
- Bidet with visible connections, without coverings
- Special size customized applications
- Any copper pipe connections

Adjustable elbows are used to ease the connection between copper pipes and water distribution net.

This range has been designed and developed with interesting technical devices allowing a quick and easy installation being adjustable either in depth and angulation.

The range includes accessories such as compression fittings, adapters and wall covers.

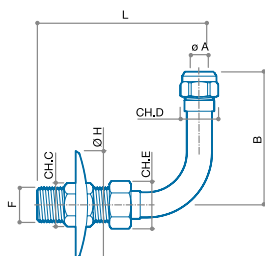

FIXED 90° ANGLE PIPE

Chromed copper elbow for pipe \varnothing 10 mm with sliding wall cover and 3 pcs cartridge.

CODE	FITTINGS	A	B	C	D	E	F	G	H	L			
05391700CC	MPR 3/8 - RCC 3/8	10	78	21	19	23	G 3/8	-	60	82	130	10	100
05392100CC	MPR 1/2 - RCC 3/8	10	78	21	19	23	G 1/2	-	60	82	134	10	100

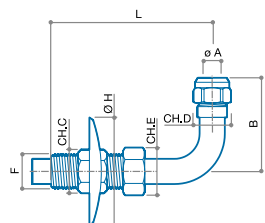

SLIDING 90° ANGLE PIPE

Chromed copper elbow for pipe \varnothing 10 mm with sliding wall cover and 3 pcs cartridge.

CODE	FITTINGS	A	B	C	D	E	F	G	H	L			
05392115CC	MPR 1/2 - RCC 3/8	10	60	21	19	23	G 1/2	-	60	120	154	10	100

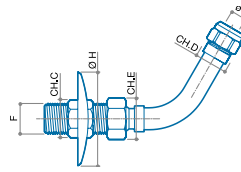

ADJUSTABLE ANGLE PIPE WITH ARTICULATED JOINT

Chromed copper elbow for pipe \varnothing 10 mm with sliding wall cover and 3 pcs cartridge.

CODE	FITTINGS	A	B	C	D	E	F	G	H	L			
05392125CC	MPR 1/2 - RCC 3/8	10	-	21	19	23	G 1/2	-	60	-	158	10	100

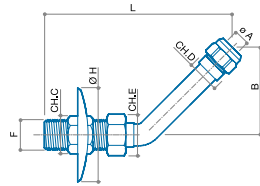

FIXED ANGLE PIPE 45°

Chromed copper elbow for pipe \varnothing 10 mm with sliding wall cover and 3 pcs cartridge.

CODE	FITTINGS	A	B	C	D	E	F	G	H	L			
05391735CC	MPR 3/8 - RCC 3/8	10	60	21	19	23	G 3/8	-	60	120	134	10	100
05392135CC	MPR 1/2 - RCC 3/8	10	60	21	19	23	G 1/2	-	60	120	138	10	100

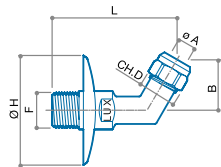

FIXED ANGLE PIPE 60°

Forged chromed brass angle for pipe \varnothing 10 mm with sliding wall cover and 3 pcs cartridge.

CODE	FITTINGS	A	B	C	D	E	F	G	H	L			
05142101CC	MPR 1/2 - RCC 3/8	10	29	-	19	-	G 1/2	-	60	70	98	10	100

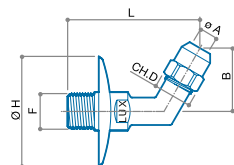

FIXED 60° ANGLE PIPE WITH HIGH NUT

Forged chromed brass angle with sliding wall cover and 3 pcs cartridge and high nut.

CODE	FITTINGS	A	B	C	D	E	F	G	H	L			
05142102CC	MPR 1/2 - RCC 3/8	10	35	-	19	-	G 1/2	-	60	72	105	10	100

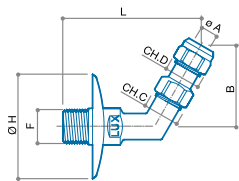

FIXED 60° ANGLE PIPE WITH EXTENSION

Forged chromed copper angle for \varnothing 10 mm pipe with sliding wall cover, 3 pcs cartridge and extension.

CODE	FITTINGS	A	B	C	D	E	F	G	H	L			
05152101CC	MPR 1/2 - RCC 3/8	10	48	19	19	-	G 1/2	-	60	82	124	10	100

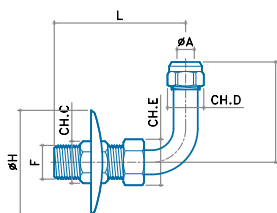

FIXED 90° ANGLE PIPE

Chromed brass elbow for \varnothing 10 mm with sliding wall cover and 3 pcs cartridge.

CODE	FITTINGS	A	B	C	D	E	F	G	H	L			
05391710CC	MPR 3/8 - RCC 3/8	10	57	21	19	23	G 3/8	-	60	76	138	10	100
05392110CC	MPR 1/2 - RCC 3/8	10	57	21	19	23	G 1/2	-	60	76	138	10	100

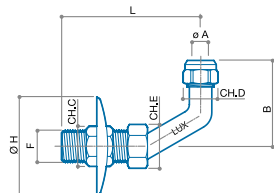

FIXED 90° ANGLE PIPE

Forged chromed brass angle for \varnothing 10 mm with sliding wall cover and 3 pcs cartridge.

CODE	FITTINGS	A	B	C	D	E	F	G	H	L			
05391750CC	MPR 3/8 - RCC 3/8	10	55	21	19	23	G 3/8	-	60	78	144	10	100
05392150CC	MPR 1/2 - RCC 3/8	10	55	21	19	23	G 1/2	-	60	78	144	10	100

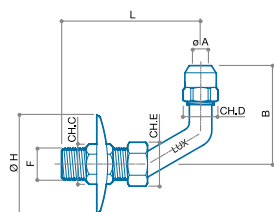

FIXED 90° ANGLE PIPE WITH HIGH NUT

Forged chromed brass angle for \varnothing 10 mm with sliding wall cover and 3 pcs cartridge and high nut.

CODE	FITTINGS	A	B	C	D	E	F	G	H	L			
05392160CC	MPR 1/2 - RCC 3/8	10	62	21	19	23	G 1/2	-	60	78	151	10	100

COMPRESSION FITTINGS

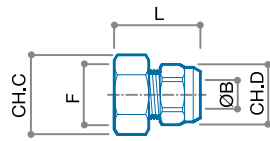

FEMALE COMPRESSION FITTING

Chromed copper fitting for copper pipe connection \varnothing 10 mm and \varnothing 12 mm.

CODE	FITTINGS	A	B	C	D	E	F	G	H	L			
3 pcs cartridge													
05301710CC	F 3/8 - RCC 3/8	-	10	20	19	-	G 3/8	-	-	30	40	30	-
05302110CC	F 1/2 - RCC 3/8	-	10	24	19	-	G 1/2	-	-	30	45	30	-
Teflon ogive													
05301712	F 3/8 - RCO 3/8	-	12	20	19	-	G 3/8	-	-	30	29	30	-
05302112	F 1/2 - RCO 3/8	-	12	24	19	-	G 1/2	-	-	30	40	30	-

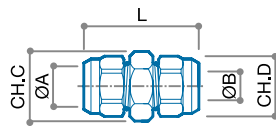

COMPRESSION NIPPLE FITTING

Chromed copper fitting for copper pipe connection \varnothing 10 mm and \varnothing 12 mm.

CODE	FITTINGS	A	B	C	D	E	F	G	H	L			
3 pcs cartridge													
05291710CC	RCC 3/8 - RCC 3/8	10	10	17	-	-	-	-	-	40	55	30	-
Teflon ogive													
05291712	RCO 3/8 - RCO 3/8	12	12	17	-	-	-	-	-	40	44	30	-

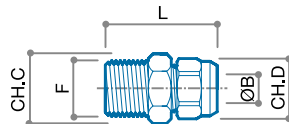

MALE COMPRESSION FITTING

Chromed brass fitting for copper pipe connection.

CODE	FITTINGS	A	B	C	D	E	F	G	H	L			
3 pcs cartridge													
05321710CC	M 3/8 - RCC 3/8	-	10	17	19	-	G 3/8	-	-	40	45	30	-
05322110CC	M 1/2 - RCC 3/8	-	10	21	19	-	G 1/2	-	-	40	50	30	-
Teflon ogive													
05321712	M 3/8 - RCO 3/8	-	12	17	19	-	G 3/8	-	-	40	35	30	-
05322112	M 1/2 - RCO 3/8	-	12	21	19	-	G 1/2	-	-	40	46	30	-
05322114	M 1/2 - RCO 1/2	-	14	21	19	-	G 1/2	-	-	40	56	20	-

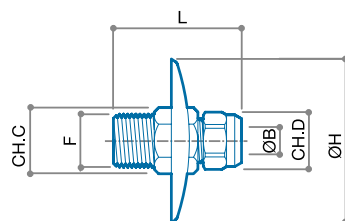

EXTENDED COMPRESSION FITTING

Chromed brass with sliding wall cover for copper pipe connection.

CODE	FITTINGS	A	B	C	D	E	F	G	H	L			
05311701CC	MPR 3/8 - RCC 3/8	-	10	17	19	-	G 3/8	-	60	48	63	20	-
05312101CC	MPR 1/2 - RCC 3/8	-	10	21	19	-	G 1/2	-	60	48	73	20	200

WALL COVER

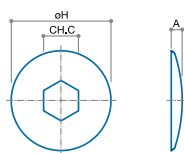
**WALL COVER WITH HEXAGONAL HOLE Ø 60**

Stainless steel sliding wall cover \varnothing 60 mm with hexagonal hole.

CODE	FITTINGS	A	B	C	D	E	F	G	H	L			
30011700CF	G 3/8	6	-	17	-	-	-	-	60	-	9	10	-
30012100CF	G 1/2	6	-	21	-	-	-	-	60	-	8	10	-

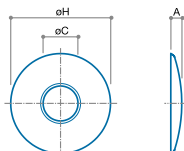
**WALL COVER WITH ROUND HOLE Ø 60**

Stainless steel wall cover \varnothing 60 mm with round hole.

CODE	FITTINGS	A	B	C	D	E	F	G	H	L			
30031700CF	G 3/8	6	-	17	-	-	-	-	60	-	9	50	-
30032100CF	G 1/2	6	-	21	-	-	-	-	60	-	8	50	-
30032700CF	G 3/4	6	-	27	-	-	-	-	60	-	7	-	50
30033400CF	G 1"	6	-	34	-	-	-	-	60	-	6	-	50

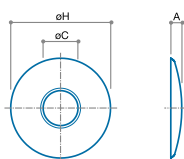
**WALL COVER WITH ROUND HOLE Ø 55**

Chromed brass wall cover \varnothing 55 mm with round hole.

CODE	FITTINGS	A	B	C	D	E	F	G	H	L			
30051700CF	G 3/8	6	-	17	-	-	-	-	55	-	7	50	-
30052100CF	G 1/2	6	-	21	-	-	-	-	55	-	6	50	-

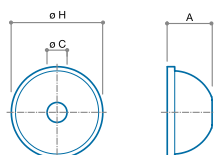

**BELL SHAPED WALL COVER**

Chromed brass wall cover \varnothing 55 mm bell shaped.

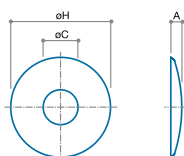
CODE	FITTINGS	A	B	C	D	E	F	G	H	L			
05260010CF	\varnothing 10	27	-	10	-	-	-	-	55	-	14	-	50
05260012CF	\varnothing 12	27	-	12	-	-	-	-	55	-	13	-	50
05260014CF	\varnothing 14	27	-	14	-	-	-	-	55	-	12	-	50

**WALL COVER WITH TONGUE Ø 57**

Stainless steel sliding wall cover \varnothing 57 mm with tongue.

CODE	FITTINGS	A	B	C	D	E	F	G	H	L			
30152100CF	G 1/2	8	-	21	-	-	-	-	57	-	9	50	-

CONDITION OF SALE

ORDERS

Contracts entered by agents or representative are not definitive until they are regularly accepted by supplier. The orders sent either through our Agents or directly, are accepted under the "General Sales Conditions" described in the present Price List terms, and will agree, without reservation, to the terms below.

INCOTERMS

The consignments are always Ex works unless differently agreed in the sales contract.

PAYMENT TERMS

The payment terms are those specified in the offers and the order confirmation and are binding.

In case of delay of payment with respect to the agreed due terms, the commercial interest shall be calculated. The delayed payment of previous supplies will authorize us to cancel all orders in progress. Agents and representative are not entitled to collect credits, unless clearly authorised in writing by the supplier.

CLAIMS

Claims on quantities will be accepted within 8 days from the date of receipt of goods. The supplier will not be responsible for missing or damaged packages, unless in the despatch note it is clearly written "accepted with reservation".

COURT

For any controversies the place of jurisdiction shall be: the Court of Law of Brescia.

PRICES

Prices indicated are those clearly agreed in the contract sales confirmed by our order confirmation.

DELIVERY TERMS

The articles part of this catalogue will be consigned within a term of 90 days from order acceptance. Any date inferior to this term is not to be considered accepted unless confirmed in order confirmation.

The delivery times are not binding for the supplier, who will not respond for any damages arising directly or indirectly from delivery delays, or from a total or partial interruption of the supply.

PACKAGING

The standard packaging is at suppliers charges.

The standard packaging does not include special out of size or particular. Where any special packaging is required this will be at customer's charges, unless previously agreed in writing in the contract sales.

RETURN OF GOODS

No goods will be accepted without our previous authorization.

MINIMUM ORDER VALUE

The supplier in addition to checking the feasibility will have the right to deliver orders with a minimum value of 500 Euro.

WARRANTY

The guarantee terms refer to article 3 and 5 of the 199/44/CE Directive. The guarantee is supported by an adequate insurance policy for the "Product Third Party Liability". The guarantee declines any responsibility whereas the installation and the test have not been correctly carried out. The wholesalers and the retailers are compelled to illustrate to their customers and installers all the useful care for a correct installation of our materials.

CATALOGUE VALIDY

Illustrations, data and references published in this issue are not binding on the supplier who reserves the right to make reasonable changes, both technical and commercial, at his discretion at any time, still without lowering the design performance of the goods.