



## 60 YEARS OF ITALIAN TRADITION

Luxor is an important industrial reality, world wide and European market leader in the production of flexible hoses and components for hydro and thermo-sanitary installations. Luxor has been the expression of the most prestigious made in Italy and the great Italian high technology mechanical workings tradition for fifty years; a quality certified and recognized by the most prestigious International Certification Institutes all over the world.

Our mission is the complete customer satisfaction through a process of continuous technological research in order to make high quality, reliable products, anticipating the market evolutions by innovative partnership with both customers and suppliers. Luxor mission takes

place in its own Research and Development Centre in which new and advanced technologies are constantly analyzed and researched with continuous investments to offer the most innovative and reliable solutions for the international markets at competitive costs, ensuring strict quality controls on each single piece.

Luxor entirely plans and realizes each product, thanks to its decennial know how. The great production strength, a "slender" innovative and advanced industrial organization together with a modern logistic conception, make Luxor able to satisfy every kind of request, even customized, with fast deliveries all over the world.



Luxor is certified ISO 9001:2015 by DEKRA Group certification body

### CERTIFICATION



Please contact our offices for information about technical specifications and certified products or visit the website of the corresponding certification body for the latter.

Please refer to [www.nsf.org](http://www.nsf.org) for a complete list of NSF approved products.  
Please refer to [www.iapmort.org](http://www.iapmort.org) for a complete list of UPC/CUPC approved products.



RADIATOR VALVES

**1.1 / EASY**

# EASY VALVES AND LOCKSHIELDS



When in closed position, the tightness is granted by an o-ring and a conical metal collar. The valves are nickel plated. Valves and lockshields must be opened with a differential pressure lower than 1 bar.



When in closed position, the tightness is granted by an o-ring and a conical metal collar. The valves are nickel plated. The flow can be adjusted by limiting the lift of the obturator.

### TECHNICAL DATA



DN

10  
15  
20



Max temperature

120 °C



Max pressure

10 bar



Max differential pressure  
1 bar



Materials

CW617N  
UNI EN  
12165:2016



Knob

white ABS  
RAL 9016



Testing

100%

### SYSTEM CONNECTIONS



**Iron pipe**  
G 3/8  
G 1/2  
G 3/4



**Copper pipe**  
W 24x19 - TR 91  
G 3/4 EK - TR 91/A

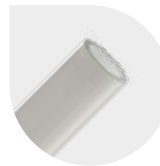

**Plastic pipe**  
W 24x19 - TP 95  
G 3/4 EK - TP 98



**Multilayer pipe**  
W 24x19 - TP 97  
G 3/4 EK - TP 99

### RADIATOR CONNECTION



**Conical milled thread**  
G 3/8  
G 1/2  
G 3/4



**Cylindrical thread with soft sealing**  
G 3/8  
G 1/2  
G 3/4

### ADVANTAGES OF THE STEM MADE IN TWO PIECES

The hydraulic seal on the fixed rod is guaranteed by a double o-Ring.

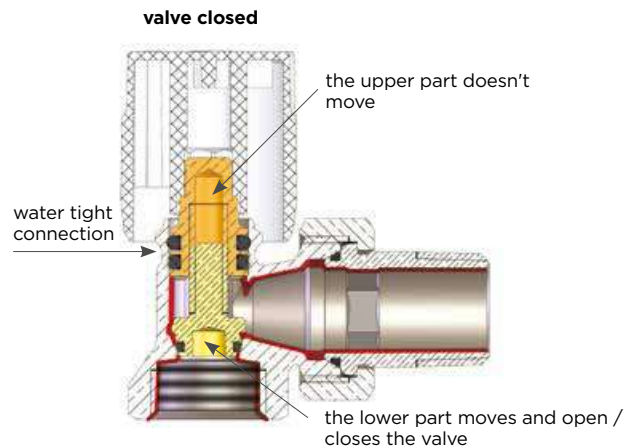
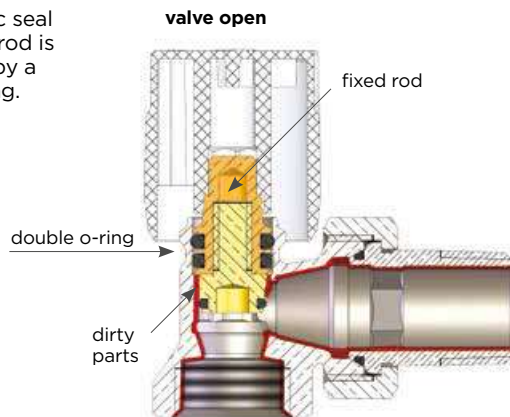

All valves and lockshields are 100% checked with an electronically controlled pneumatic test.

The characteristics of the fluid in the system must be compliant with the UNI 8065: 2019 directive.

## ADVANTAGES OF THE STEM MADE IN TWO PIECES

## TWO PIECES STEM

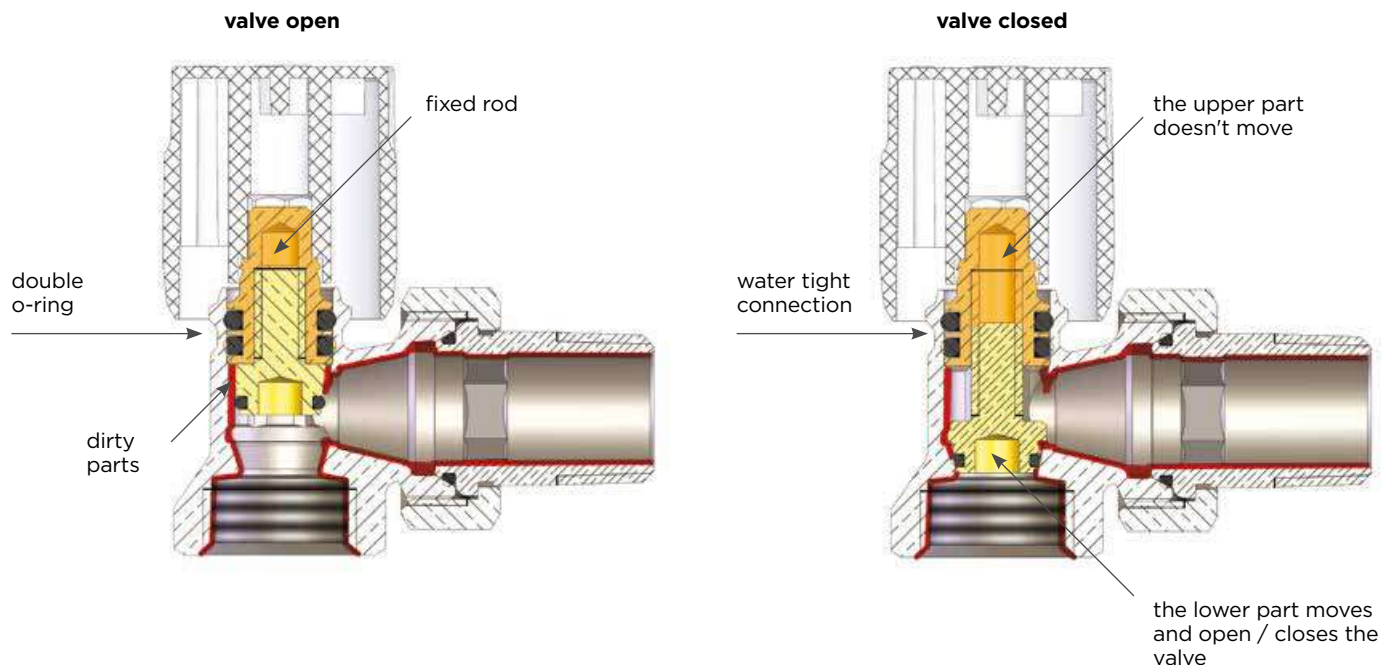

## ONE PIECE STEM

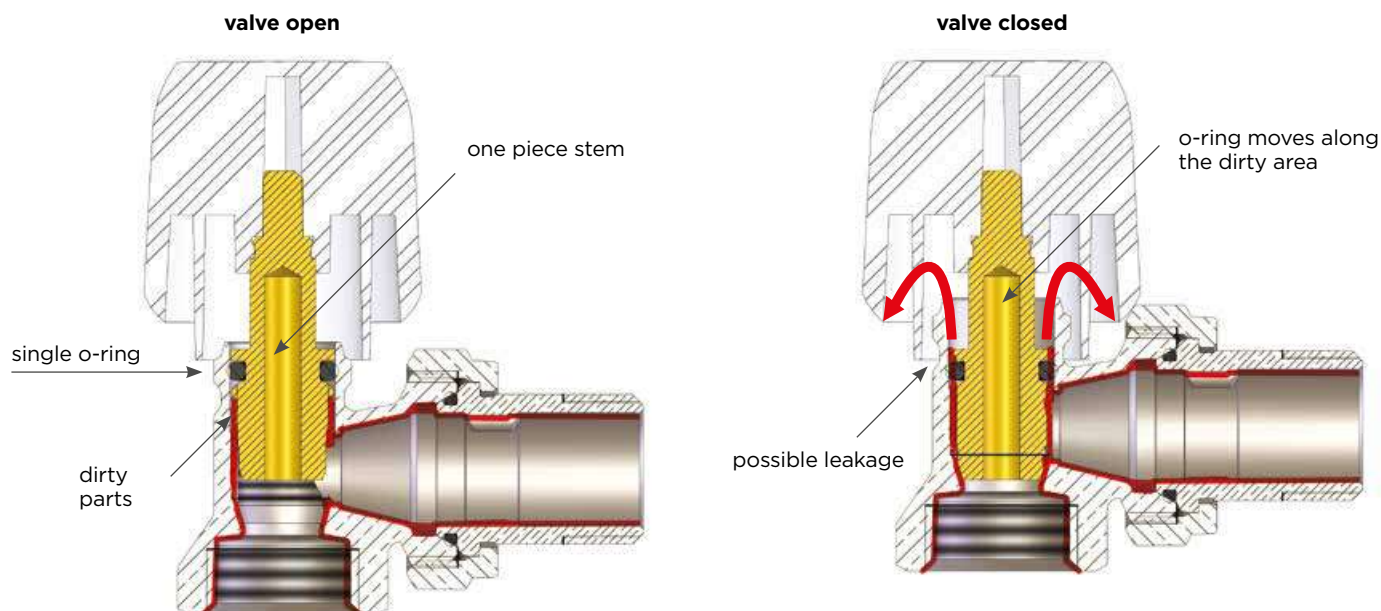

The benefit of the rod made in two pieces are many and occur both with the valve open and with the valve closed. The fixed rod, with double o-ring, guarantees the seal and prevents impurities from settling in the seat where these gaskets work, avoiding the decrease in their effectiveness.

In the sliding rod, however, this considerable benefit is not guaranteed as the working surface of the gaskets is exposed to the impurities of the fluid in the system. This can greatly increase the possibility of fluid loss, especially in the medium to long term.

### CONNECTION FOR IRON PIPE

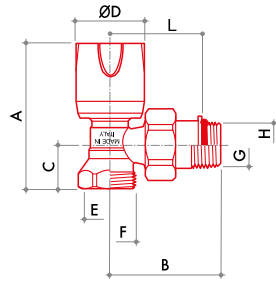

**RS 102**

Single adjustment angle radiator valve. Connection for iron pipe.

Fittings



CODE	SIZE	A	B	C	D	E	F	G	H	L			
11021700	DN 10 3/8	65	49	18	32	G 3/8	-	R 3/8	-	-	137	10	80
11022100	DN 15 1/2	67	51	20	32	G 1/2	-	R 1/2	-	-	170	10	80
11022700	DN 20 3/4	70	61	25	32	G 3/4	-	R 3/4	-	-	254	8	64

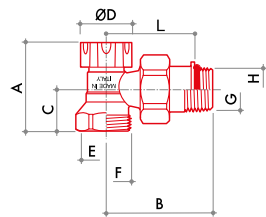

**DS 122**

Angle regulating lockshield. Connection for iron pipe.

Fittings



CODE	SIZE	A	B	C	D	E	F	G	H	L			
11061700	DN 10 3/8	40	49	18	25	G 3/8	-	R 3/8	-	-	121	10	80
11062100	DN 15 1/2	42	51	20	25	G 1/2	-	R 1/2	-	-	154	10	80
11062700	DN 20 3/4	47	61	25	25	G 3/4	-	R 3/4	-	-	238	8	64

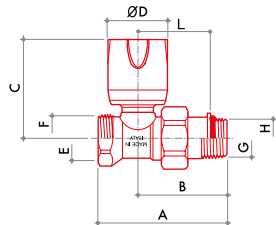

**RD 101**

Single adjustment straight radiator valve. Connection for iron pipe.

Fittings



CODE	SIZE	A	B	C	D	E	F	G	H	L			
11221700	DN 10 3/8	65	45	53	32	G 3/8	-	R 3/8	-	-	142	10	80
11222100	DN 15 1/2	68	47	53	32	G 1/2	-	R 1/2	-	-	176	10	80
11222700	DN 20 3/4	80	56	55	32	G 3/4	-	R 3/4	-	-	265	8	64

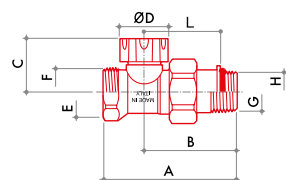

**DD 121**

Straight regulating lockshield. Connection for iron pipe.

Fittings



CODE	SIZE	A	B	C	D	E	F	G	H	L			
11261700	DN 10 3/8	65	45	28	25	G 3/8	-	R 3/8	-	-	132	10	80
11262100	DN 15 1/2	68	47	28	25	G 1/2	-	R 1/2	-	-	161	10	80
11262700	DN 20 3/4	80	56	29	25	G 3/4	-	R 3/4	-	-	248	8	64



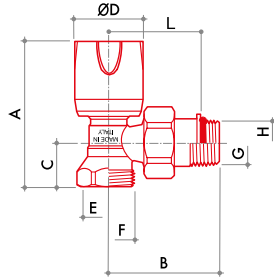

**RS 106**

Single adjustment angle radiator valve.  
Connection for iron pipe.

Fittings



CODE	SIZE	A	B	C	D	E	F	G	H	L			
11022117	DN 10 3/8	65	46	18	32	G 3/8	-	-	G 3/8	36	143	10	80
11022103	DN 15 1/2	65	47	20	32	G 1/2	-	-	G 1/2	37	174	10	80
11022703	DN 20 3/4	70	58	25	32	G 3/4	-	-	G 3/4	46	257	8	64

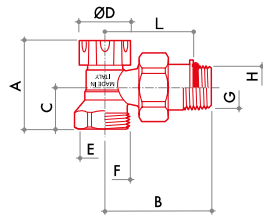

**DS 126**

Angle regulating lockshield.  
Connection for iron pipe.

Fittings



CODE	SIZE	A	B	C	D	E	F	G	H	L			
11062117	DN 10 3/8	40	46	18	25	G 3/8	-	-	G 3/8	36	127	10	80
11062103	DN 15 1/2	42	47	20	25	G 1/2	-	-	G 1/2	37	158	10	80
11062703	DN 20 3/4	47	59	25	25	G 3/4	-	-	G 3/4	47	241	8	64

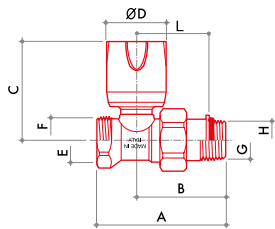

**RD 105**

Single adjustment straight radiator valve.  
Connection for iron pipe.

Fittings



CODE	SIZE	A	B	C	D	E	F	G	H	L			
11222117	DN 10 3/8	62	42	53	32	G 3/8	-	-	G 3/8	32	148	10	80
11222103	DN 15 1/2	64	43	53	32	G 1/2	-	-	G 1/2	33	180	10	80
11222703	DN 20 3/4	77	53	55	32	G 3/4	-	-	G 3/4	41	268	8	64

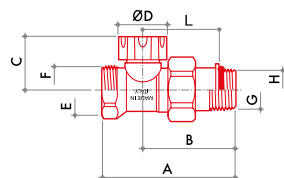

**DD 125**

Straight regulating lockshield.  
Connection for iron pipe.

Fittings



CODE	SIZE	A	B	C	D	E	F	G	H	L			
11262117	DN 10 3/8	62	42	28	25	G 3/8	-	-	G 3/8	32	138	10	80
11262103	DN 15 1/2	64	43	28	25	G 1/2	-	-	G 1/2	33	165	10	80
11262703	DN 20 3/4	78	54	29	35	G 3/4	-	-	G 3/4	42	251	8	64



Fittings for copper pipe



Fittings for plastic pipe



Fittings for multilayer pipe



Fittings: chapter 7



Accessories: chapter 1.A

## CONNECTION FOR COPPER AND PLASTIC PIPE W24X19

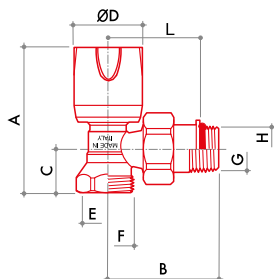

### RS 112

Single adjustment angle radiator valve. Connection for copper and plastic pipe.

Fittings



CODE	SIZE	A	B	C	D	E	F	G	H	L			
11121700	DN 10 3/8	67	49	20	32	-	W24x19	R 3/8	-	-	138	10	80
11122100	DN 15 1/2	66	51	20	32	-	W24x19	R 1/2	-	-	159	10	80

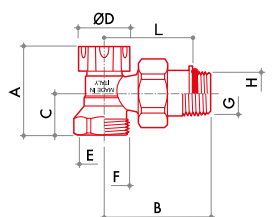

### DS 132

Angle regulating lockshield. Connection for copper and plastic pipe.

Fittings



CODE	SIZE	A	B	C	D	E	F	G	H	L			
11161700	DN 10 3/8	42	49	20	25	-	W24x19	R 3/8	-	-	122	10	80
11162100	DN 15 1/2	42	51	20	25	-	W24x19	R 1/2	-	-	143	10	80

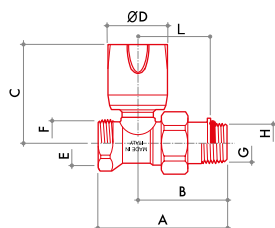

### RD 111

Single adjustment straight radiator valve. Connection for copper and plastic pipe.

Fittings



CODE	SIZE	A	B	C	D	E	F	G	H	L			
11321700	DN 10 3/8	65	45	53	32	-	W24x19	R 3/8	-	-	144	10	80
11322100	DN 15 1/2	68	47	53	32	-	W24x19	R 1/2	-	-	165	10	80

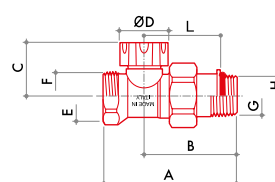

### DD 131

Straight regulating lockshield. Connection for copper and plastic pipe.

Fittings



CODE	SIZE	A	B	C	D	E	F	G	H	L			
11361700	DN 10 3/8	65	45	28	25	-	W24x19	R 3/8	-	-	133	10	80
11362100	DN 15 1/2	68	47	27	25	-	W24x19	R 1/2	-	-	150	10	80

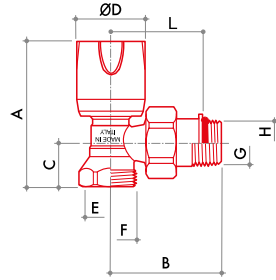

**RS 119**

Single adjustment angle radiator valve. Connection for copper and plastic pipe.

Fittings



CODE	SIZE	A	B	C	D	E	F	G	H	L			
11122117	DN 10 3/8	67	46	20	32	-	W24x19	-	G 3/8	36	148	10	80
11122103	DN 15 1/2	66	47	20	32	-	W24x19	-	G 1/2	37	162	10	80

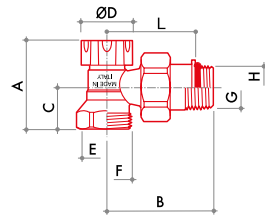

**DS 139**

Angle regulating lockshield. Connection for copper and plastic pipe.

Fittings



CODE	SIZE	A	B	C	D	E	F	G	H	L			
11162117	DN 10 3/8	42	46	20	25	-	W24x19	-	G 3/8	36	132	10	80
11162103	DN 15 1/2	42	47	20	25	-	W24x19	-	G 1/2	37	145	10	80

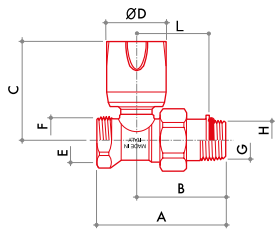

**RD 118**

Single adjustment straight radiator valve. Connection for copper and plastic pipe.

Fittings



CODE	SIZE	A	B	C	D	E	F	G	H	L			
11322117	DN 10 3/8	63	42	53	32	-	W24x19	-	G 3/8	32	152	10	80
11322103	DN 15 1/2	64	43	53	32	-	W24x19	-	G 1/2	33	171	10	80

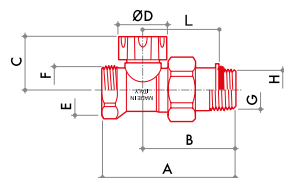

**DD 138**

Straight regulating lockshield. Connection for copper and plastic pipe.

Fittings



CODE	SIZE	A	B	C	D	E	F	G	H	L			
11362117	DN 10 3/8	63	42	28	25	-	W24x19	-	G 3/8	32	142	10	80
11362103	DN 15 1/2	64	43	27	25	-	W24x19	-	G 1/2	33	161	10	80



Fittings for copper pipe



Fittings for plastic pipe



Fittings for multilayer pipe



Fittings: chapter 7



Accessories: chapter 1.A



## CONNECTION FOR COPPER AND PLASTIC PIPE G3/4 EUROKONUS

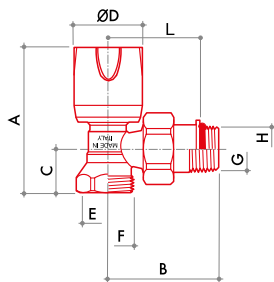

### RS 112/A

Single adjustment angle radiator valve. Connections eurokonus type.

Fittings



CODE	SIZE	A	B	C	D	E	F	G	H	L			
11122718	DN 10 3/8	65	49	20	32	-	G 3/4 EK	R 3/8	-	-	148	10	80
11122721	DN 15 1/2	66	51	20	32	-	G 3/4 EK	R 1/2	-	-	161	10	80

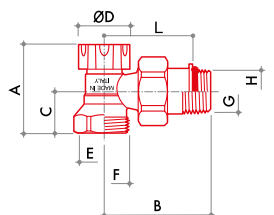

### DS 132/A

Angle regulating lockshield. Connections eurokonus type.

Fittings



CODE	SIZE	A	B	C	D	E	F	G	H	L			
11162718	DN 10 3/8	42	49	20	25	-	G 3/4 EK	R 3/8	-	-	130	10	80
11162721	DN 15 1/2	42	51	20	25	-	G 3/4 EK	R 1/2	-	-	144	10	80

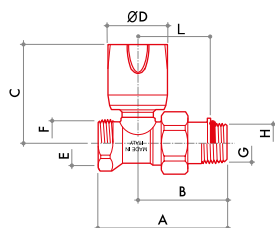

### RD 111/A

Single adjustment straight radiator valve. Connections eurokonus type.

Fittings



CODE	SIZE	A	B	C	D	E	F	G	H	L			
11322719	DN 10 3/8	66	45	53	32	-	G 3/4 EK	R 3/8	-	-	149	10	80
11322722	DN 15 1/2	69	48	53	32	-	G 3/4 EK	R 1/2	-	-	170	10	80

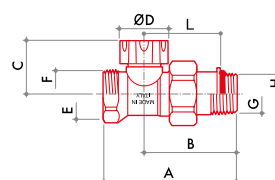

### DD 131/A

Straight regulating lockshield. Connections eurokonus type.

Fittings



CODE	SIZE	A	B	C	D	E	F	G	H	L			
11362719	DN 10 3/8	66	45	28	25	-	G 3/4 EK	R 3/8	-	-	138	10	80
11362722	DN 15 1/2	69	48	28	25	-	G 3/4 EK	R 1/2	-	-	160	10	80

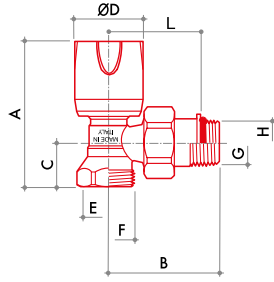

**RS 119/A**

Single adjustment angle radiator valve.  
Connections eurokonus type.

Fittings



CODE	SIZE	A	B	C	D	E	F	G	H	L			
11122717	DN 10 3/8	66	46	20	32	-	G 3/4 EK	-	G 3/8	36	151	10	80
11122703	DN 15 1/2	66	47	20	32	-	G 3/4 EK	-	G 1/2	37	165	10	80

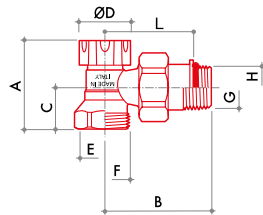

**DS 139/A**

Angle regulating lockshield.  
Connections eurokonus type.

Fittings



CODE	SIZE	A	B	C	D	E	F	G	H	L			
11162717	DN 10 3/8	42	46	20	25	-	G 3/4 EK	-	G 3/8	36	135	10	80
11162703	DN 15 1/2	42	47	20	25	-	G 3/4 EK	-	G 1/2	37	148	10	80

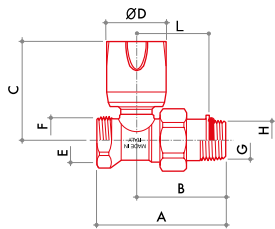

**RD 118/A**

Single adjustment straight radiator valve.  
Connections eurokonus type.

Fittings



CODE	SIZE	A	B	C	D	E	F	G	H	L			
11322717	DN 10 3/8	63	42	53	32	-	G 3/4 EK	-	G 3/8	32	155	10	80
11322703	DN 15 1/2	64	43	53	32	-	G 3/4 EK	-	G 1/2	33	174	10	80

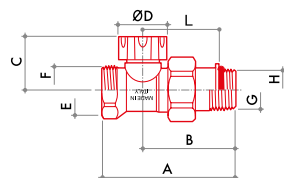

**DD 138/A**

Straight lockshield regulating valve.  
Connections eurokonus type.

Fittings



CODE	SIZE	A	B	C	D	E	F	G	H	L			
11362717	DN 10 3/8	63	42	28	25	-	G 3/4 EK	-	G 3/8	32	145	10	80
11362703	DN 15 1/2	64	43	27	25	-	G 3/4 EK	-	G 1/2	33	164	10	80



Fittings for copper pipe



Fittings for plastic pipe



Fittings for multilayer pipe



Fittings: chapter 7



Accessories: chapter 1.A

### VALVES FLOW RATE CHART

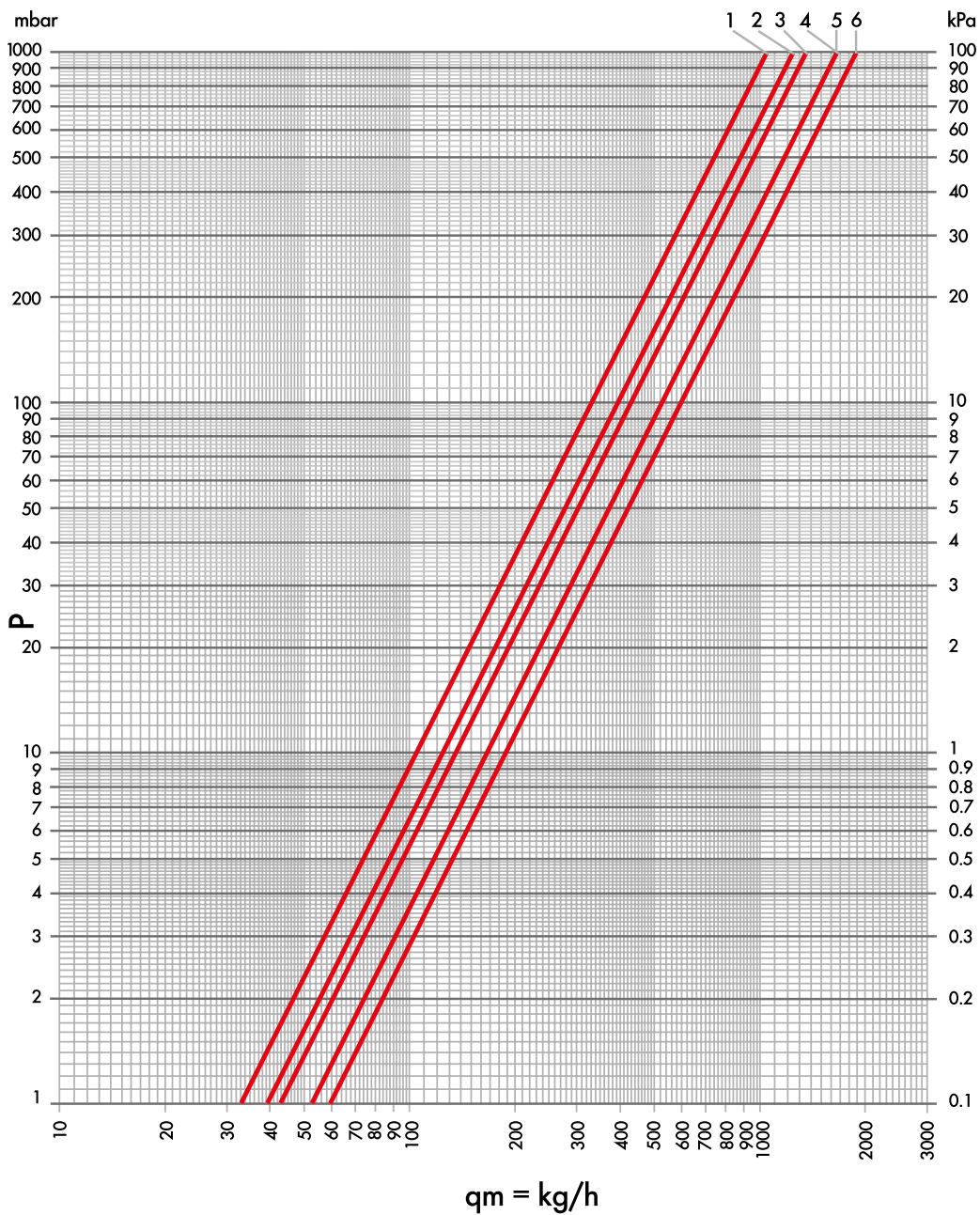

ITEM	Kv	POS
RD 101 3/8 - RD 105 3/8 - RD 111 3/8 RD 118 3/8 - RD 118/A 3/8	1.05	1
RD 101 1/2 - RD 105 1/2 - RD 111 1/2 RD 111/A 1/2 - RD 118 1/2 - RD 118/A 1/2	1.25	2
RD 101 3/4 - RD 105 3/4	1.35	3
RS 102 3/8 - RS 106 3/8 - RS 112 3/8 RS 119 3/8 - RS 119/A 3/8	1.65	4
RS 102 1/2 - RS 106 1/2 - RS 112 1/2 RS 112/A 1/2 - RS 119 1/2 - RS 119/A 1/2	1.65	5
RS 102 3/4 - RS 106 3/4	1.90	6

### LOCKSHIELD FLOW RATE CHART

#### ANGLE LOCKSHIELD

DN 10 3/8 - DN 15 1/2

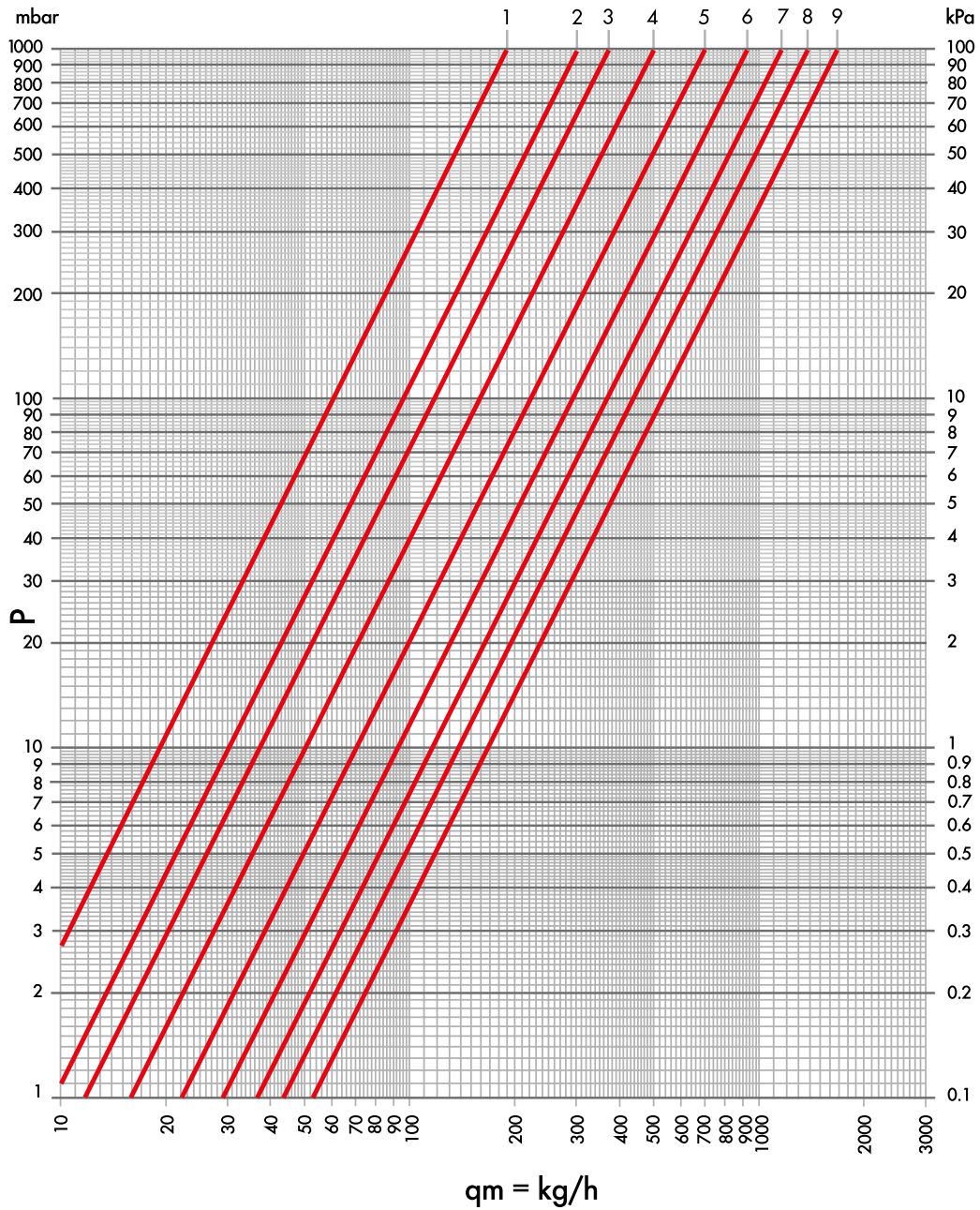

ITEM	TURNS N°	Kvs	POS
DS 122 DS 126 DS 132 DS 139 DS 132/A DS 139/A	1	0.19	1
	1+1/2	0.30	2
	2	0.37	3
	2+1/2	0.50	4
	3	0.69	5
	3+1/2	0.92	6
	4	1.14	7
	4+1/2	1.39	8
	all open	1.65	9

### LOCKSHIELD FLOW RATE CHART

#### ANGLE LOCKSHIELD

DN 20 3/4

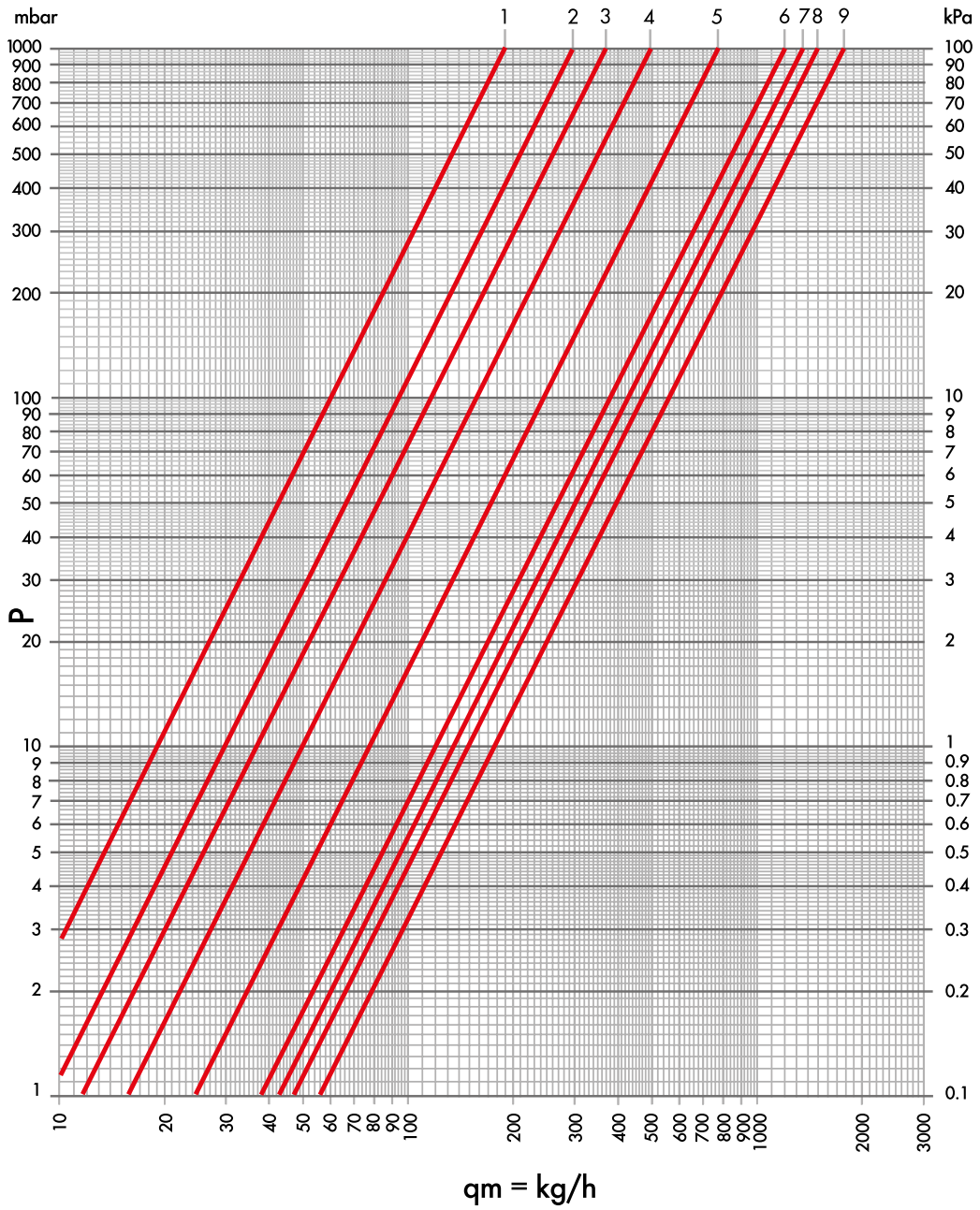

ITEM	TURNS N°	Kvs	POS
DS 122 DS 126 DS 132 DS 139 DS 132/A DS 139/A	1	0.19	1
	1+1/2	0.30	2
	2	0.37	3
	2+1/2	0.50	4
	3	0.78	5
	3+1/2	1.19	6
	4	1.34	7
	4+1/2	1.50	8
	all open	1.75	9

### LOCKSHIELD FLOW RATE CHART

#### STRAIGHT LOCKSHIELD

DN 10 3/8 - DN 15 1/2

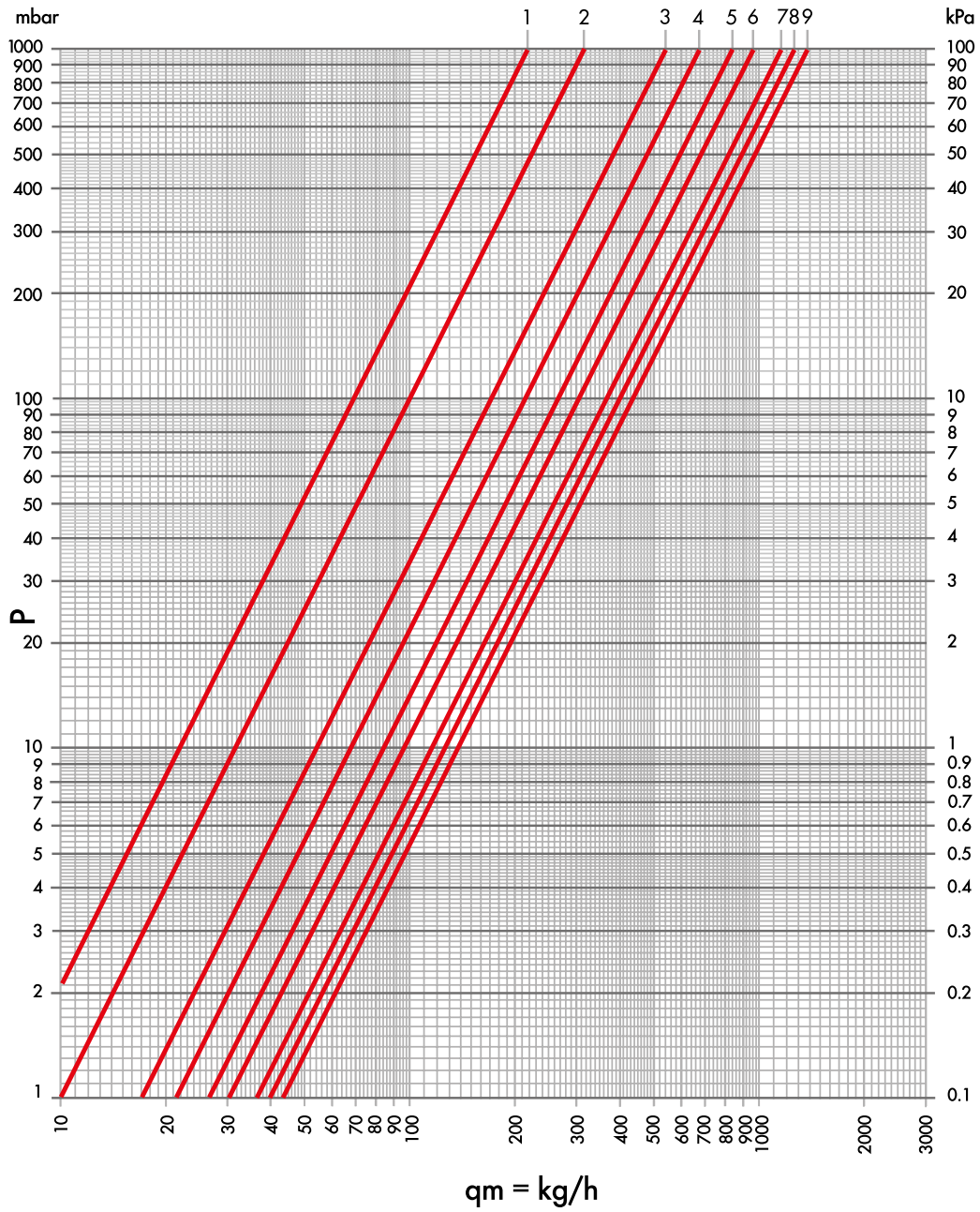

ITEM	TURNS N°	Kvs	POS
DD 121 DD 125 DD 131 DD 138 DD 131/A DD 138/A	1	0.22	1
	1+1/2	0.32	2
	2	0.53	3
	2+1/2	0.68	4
	3	0.84	5
	3+1/2	0.97	6
	4	1.14	7
	4+1/2	1.25	8
	all open	1.34	9



### LOCKSHIELD FLOW RATE CHART

#### STRAIGHT LOCKSHIELD

DN 20 3/4

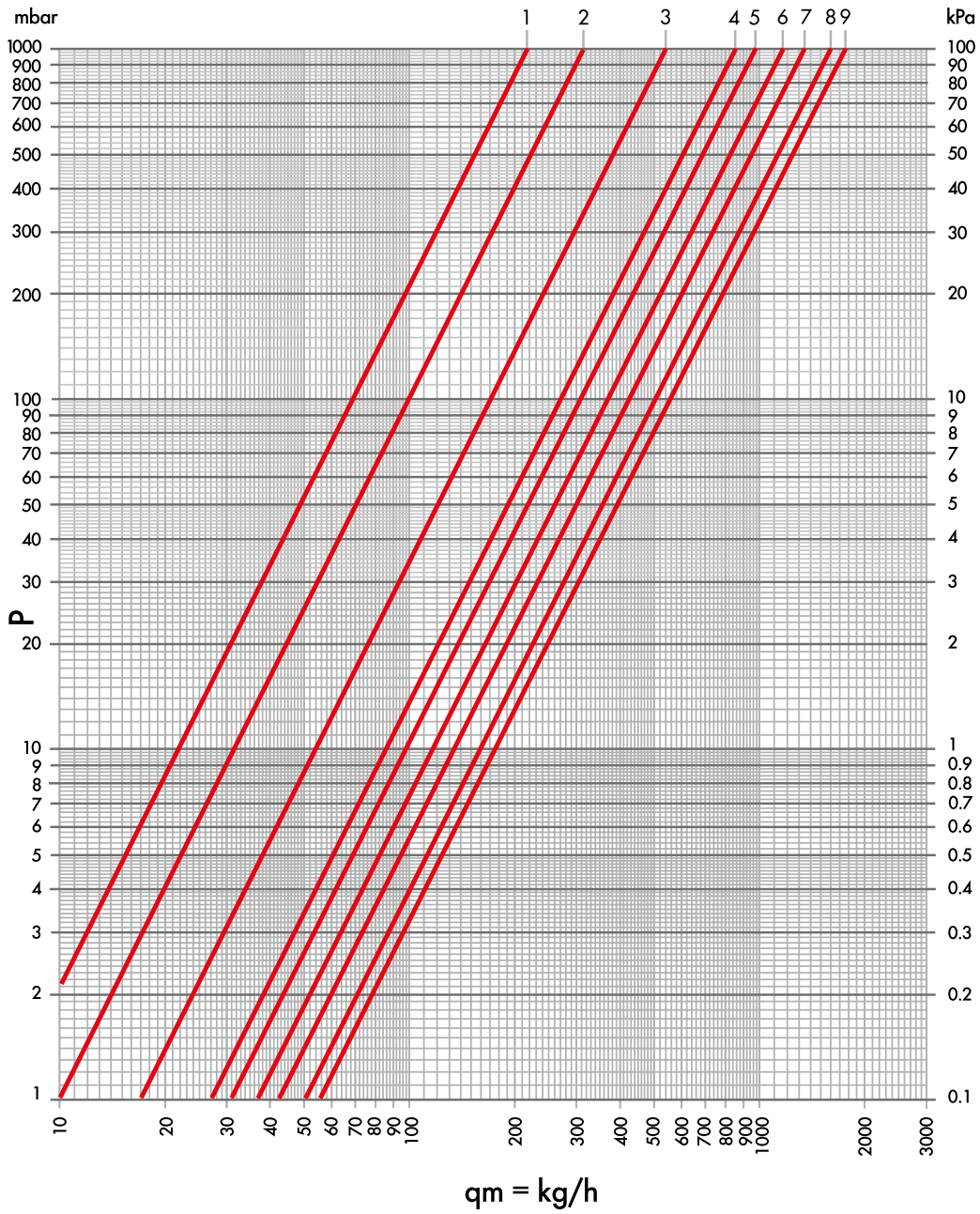

ITEM	TURNS N°	Kvs	POS
DD 121 DD 125 DD 131 DD 138 DD 131/A DD 138/A	1	0.22	1
	1+1/2	0.32	2
	2	0.54	3
	2+1/2	0.85	4
	3	0.97	5
	3+1/2	1.19	6
	4	1.34	7
	4+1/2	1.60	8
	all open	1.75	9

## CONDITION OF SALE

### ORDERS

Contracts entered by agents or representative are not definitive until they are regularly accepted by supplier. The orders sent either through our Agents or directly, are accepted under the "General Sales Conditions" described in the present Price List terms, and will agree, without reservation, to the terms below.

### INCOTERMS

The consignments are always Ex works unless differently agreed in the sales contract.

### PAYMENT TERMS

The payment terms are those specified in the offers and the order confirmation and are binding.

In case of delay of payment with respect to the agreed due terms, the commercial interest shall be calculated. The delayed payment of previous supplies will authorize us to cancel all orders in progress. Agents and representative are not entitled to collect credits, unless clearly authorised in writing by the supplier.

### CLAIMS

Claims on quantities will be accepted within 8 days from the date of receipt of goods. The supplier will not be responsible for missing or damaged packages, unless in the despatch note it is clearly written "accepted with reservation".

### COURT

For any controversies the place of jurisdiction shall be: the Court of Law of Brescia.

### PRICES

Prices indicated are those clearly agreed in the contract sales confirmed by our order confirmation.

### DELIVERY TERMS

The articles part of this catalogue will be consigned within a term of 90 days from order acceptance. Any date inferior to this term is not to be considered accepted unless confirmed in order confirmation.

The delivery times are not binding for the supplier, who will not respond for any damages arising directly or indirectly from delivery delays, or from a total or partial interruption of the supply.

### PACKAGING

The standard packaging is at suppliers charges.

The standard packaging does not include special out of size or particular. Where any special packaging is required this will be at customer's charges, unless previously agreed in writing in the contract sales.

### RETURN OF GOODS

No goods will be accepted without our previous authorization.

### MINIMUM ORDER VALUE

The supplier in addition to checking the feasibility will have the right to deliver orders with a minimum value of 500 Euro.

### WARRANTY

The guarantee terms refer to article 3 and 5 of the 199/44/CE Directive. The guarantee is supported by an adequate insurance policy for the "Product Third Party Liability". The guarantee declines any responsibility whereas the installation and the test have not been correctly carried out. The wholesalers and the retailers are compelled to illustrate to their customers and installers all the useful care for a correct installation of our materials.

### CATALOGUE VALIDY

Illustrations, data and references published in this issue are not binding on the supplier who reserves the right to make reasonable changes, both technical and commercial, at his discretion at any time, still without lowering the design performance of the goods.